

EATON

Phone: 330-535-7105
Murdock Industrial Inc. USA / GLOBAL
Fast Quotes: Sales@MurdockIndustrial.com

Fax: 330-535-1125

Accessories Catalog

Hose Cleaning System
Hose Support Clamps
Sleeves and Shields
Coils

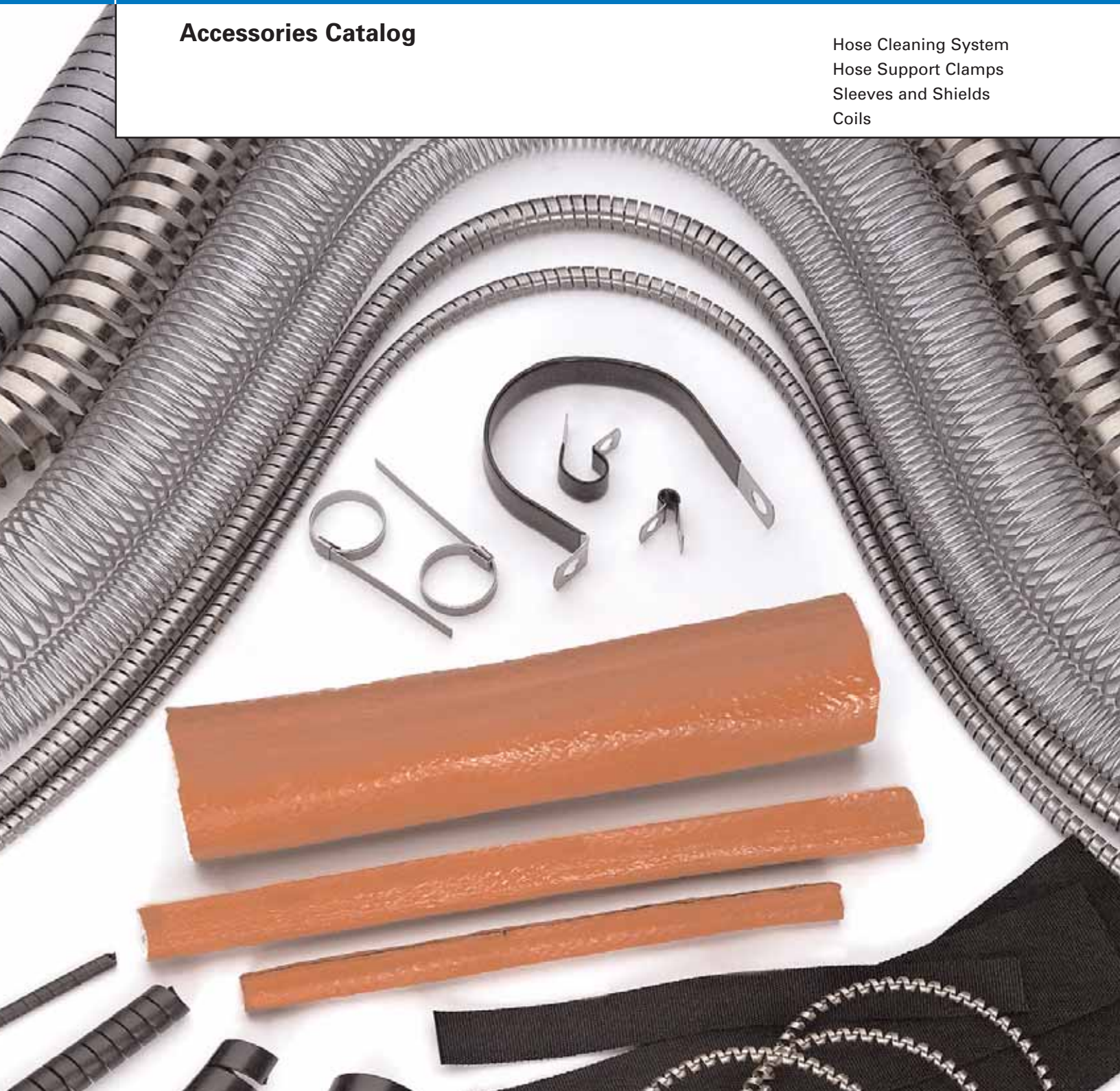

Table of Contents

Assembly Instructions	
Hose with Sleeve	3
Accessories	
Hose Cleaning System and Insertion Gages	5
Hose Protectors	6
Hose Spacers and Looms	7
Support Clamps	8
Sleeving	10
Bundling Straps	12
Protective Coils, Sleeves & Clamps	14
AQ Hose Accessories Selection Chart	18
WH Hose Sleeves and Guards Selection Chart	29



Assembly Instructions

Hose with Sleeve

Steel Protective Coil Sleeve



**Part No. 900705
A2900
(sleeve)**

Steel Protective Coil Spring



**Part No. 900564
A1900
(spring)**

(Refer to page 14)

Plastic Coil Sleeve



**Part No. 900952
(sleeve)**

(Refer to page 15)

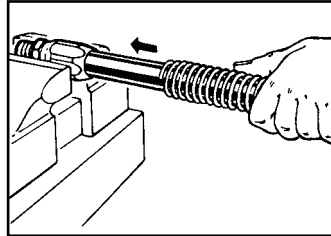

Step 1

Follow the appropriate assembly instructions through the assembly of one end fitting. Insert one end fitting in vise.

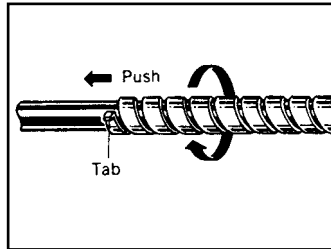

Step 2

Cut coil length. Coil should be cut to overall assembly length "OA" minus the sum of the overall length of each end fitting. ("A" dimension).

Step 3

3a Steel Protective Coil Sleeve

The hose and the coil should be held straight. Taping or capping the hose end can prevent frayed wire ends from snagging on the coil. Bend one end to the coil outward to form a slight tab to assist grasping. (Cut off or bend back when installation is complete.) Hold the tab with the thumb of one hand while twisting the coil clockwise approximately one foot back from the coil tab. When the coil opens up sufficiently, slip the tab end to the coil over the hose. Move the coil onto the hose by pulling at the tab end while pushing with the other hand. Be careful not to exceed the resiliency of the coil by stretching it too far.

3b Steel Protective Coil Spring

Slide coil over hose.

Step 4

Proceed with assembly of second end fitting.

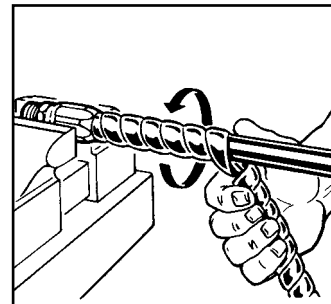

Step 1

Follow the appropriate hose assembly instructions through the assembly of both end fittings. Insert end fitting in vise.

Step 2

Cut coil length. Coil should be cut to overall assembly length "OA" minus the sum of the overall length of each end fitting. ("A" dimension).

Step 3

Wrap the coil on the hose.

Assembly Instructions

Hose with Sleeve

Bundling Sleeves

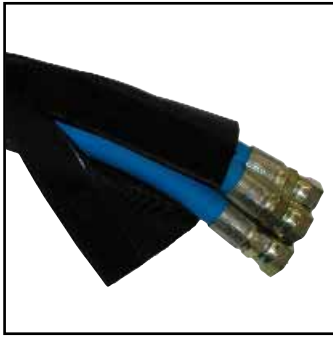

**Part No. FC676
A4900**

(Refer to page 10)

Assembly procedures

- 1.) Measure the length of bundling sleeve required and cut to length.
- 2.) Begin folding over the bottom portions of the sleeve material.
- 3.) Fold over one end of the hook & loop material and fasten to the bottom. Work your way up the entire length of sleeve this way.
- 4.) Your hoses are now secure and bundled.

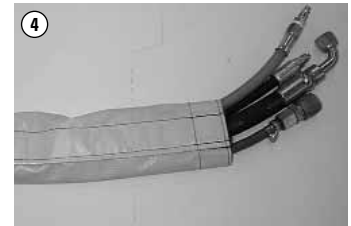
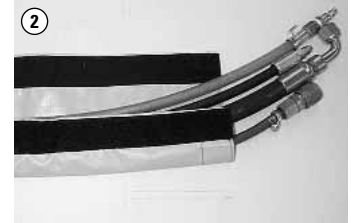

Firesleeve



**Part No. 624
A6900**

(Refer to page 15)

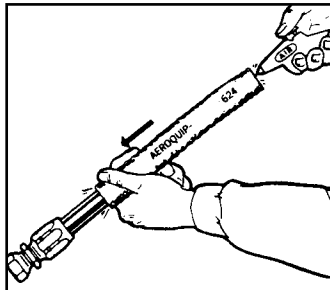

Step 1

Follow the appropriate hose assembly instructions through the assembly of one end fitting. Cut firesleeve to same length as hose.

Start firesleeve over cut end of hose. **Note:** If applying sleeve over Teflon or stripped cover assemblies, wrap exposed wire with tape. Grasp sleeve and slip over the hose assembly as illustrated.

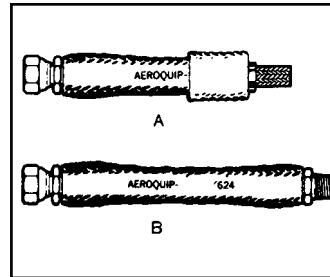

Step 2

Skin sleeve back from cut end of hose enough to allow assembly of second end fitting. (2A)

Then center sleeve so that it completely covers both sockets. (2B)

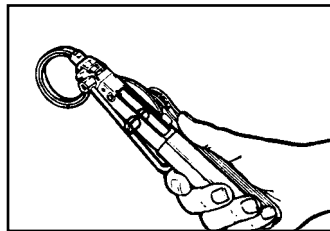

Step 3

Insert tail of band clamp into hand clamping tool.

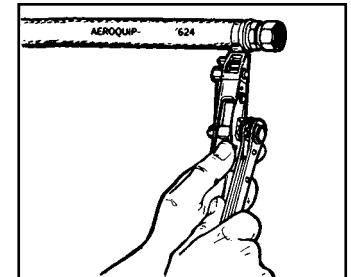

Step 4

Position band clamp over sleeve as shown and then draw tight with hand tool. Remove tool and cut free end of band clamp. Repeat on other end of assembly. To complete, bend protruding tail of clamp over clamp buckle.

Accessories

Hose Cleaning System and Insertion Gages

Hose Cleaning System Hose Kit



**Part No. FT1355-01
FT1355-02**

The Jetcleaner™ hose cleaning system offers a revolutionary solution for the internal cleaning of bulk hose and finished hose assemblies. Using a low pressure air gun, the Jetcleaner system routes a foam projectile through the hose to thoroughly remove debris remaining from cutting, skiving and assembly operations. Available in kit form or as individual components, the Jetcleaner hose cleaning system is the system of choice for hose assembly professionals.

FT1355-01 includes:

Jetcleaner™ pistol, Hose nozzles, 1/4" through 2" ID, Adapter ring, Bench stand, Aluminum case, Quick disconnect coupling

Note: Hose projectiles (P/N FT1355-3-size) not included in kit.

FT1355-02

Includes Jetcleaner™ pistol, Hose nozzles, 1/4" through 1-1/4" ID, Adapter ring, Bench stand, Aluminum case, Quick disconnect coupling, and Hose projectiles

Also available individually:

- Jetcleaner™ pistol – FT1355-1-01
- Hose nozzles – FT1355-2-size
- Hose projectiles – FT1355-3-size
- Coupling nozzles – FT1355-4-size
- Coupling projectiles – FT1355-5-size
- Adapter ring – FT1355-10-01
- Carrying case – FT1355-11-02
- Bench stand – FT1355-12-01

Hose Insertion Gages



Part No. FF90308

FOR USE WITH ALL HOSES THAT MATE WITH TTC, TTC12 AND SPIRAL TTC FITTINGS, Z-FITTINGS

Improve hose assembly reliability with these easy to use aluminum gages that are designed to ensure proper fitting depth during pre-assembly.

Simply bottom the hose in the appropriately marked cavity and scribe a mark on the hose flush with the top surface of the gage. Insert the fitting until the back of the socket is aligned with scribe line.

PART NUMBER	USAGE
FF90308-01	For use with all hoses that mate with -4 through -16 TTC, TTC12 fittings and Z-fittings
FF90308-02	For use with all hoses that mate with -20 through -32 TTC, TTC 12 fittings and Z-fittings
FF90308-03	For use with all hoses that mate with -12, -16, -20 Spiral TTC fittings and Z-fittings

Accessories

Hose Protectors

Hose Protectors

PART NUMBER	DESCRIPTION
HP4*	4" Hose Protector Case of 50
HP6*	6" Hose Protector Case of 50
HP8*	8" Hose Protector Case of 50
HPM*	Mixed Hose Protectors Case of 60

*Hose protectors available in black, orange or yellow.

Abrasion Protection For:

- Hydraulic Hoses
- Battery Cables
- Wiring Harness
- Brake Systems
- Fuel Lines
- Air Lines
- Radiator Hoses
- Oil Lines

Features:

- Extremely high wear factor
- Formulated to resist solvents, oils, grease, gasoline, etc.
- 3 grooves protect cable ties and prevent slipping
- Operating temperature range is -40° to 430°F.
- Exceptionally cost effective
- Easy installation in minutes – no need to remove hose
- Packed in easy to assemble, colorful, counter display box
- Available in 3 sizes – 4", 6" and 8" – cable ties included

Market Applications:

- Farming
- Industrial
- Trucking
- Mining
- Construction
- Aviation Support
- Public Transportation
- Road Maintenance
- Waste Management
- Original Equip. Manuf.



Accessories

Hose Spacers and Looms

Hose Spacers

PART NUMBER	DESCRIPTION
HSM-48	Case of 48 mixed Hose Spacers

Features:

- Prevents hose abrasion at points of contact
- Helps keep hoses organized
- Prevents damage from unrestrained hoses
- Easy to install
- Available in 4 sizes – $\frac{3}{4}$ ", 1", $1\frac{1}{8}$ ", $1\frac{1}{2}$ "
- Packed in colorful counter display boxes of 48 – cable ties included
- Also available in mixed boxes of 48 (12 each size) or refill bags of 12



Hose Looms

PART NUMBER	DESCRIPTION
HLM-48	Case of 48 mixed Hose Looms

Features:

- Prevents hose abrasion at points of contact
- Keeps multiple hoses organized
- Simplifies hose routing
- Prevents damage from unrestrained hoses
- Easy to install
- Available in 4 sizes – $\frac{3}{4}$ ", 1", $1\frac{1}{8}$ ", $1\frac{1}{2}$ "
- Packed in colorful counter display boxes of 48
- Also available in mixed boxes of 48 (12 each size) or refill bags of 12



Accessories

Support Clamps

Support Clamp



Aeroquip
Part No. 900729

These light weight vinyl-coated steel support clamps are designed to support hose where long runs are necessary.

This clamp not only furnishes a cleaner installation, but prevents damage, exposure and chafing.

The lining will withstand high ambient temperatures.

Bolt hole dia: Clamp dash no. -01 thru -8, -18 thru -23 is .406; -9 thru -17, -24 thru -31 is .531.

CLAMP DASH NO.	CLAMP I.D. CLOSED (IN.)	CLAMP DASH NO.	CLAMP I.D. CLOSED (IN.)
-18	.25	-19	.38
-01	.44	-1	.50
-2	.56	-21	.63
-3	.69	-4	.75
-5	.81	-6	.94
-23	1.00	-8	1.06
-9	1.13	-27	1.19
-24	1.25	-25	1.31
-10	1.50	-11	1.56
-12	1.75	-28	1.81
-13	2.00	-29	2.06
-14	2.25	-30	2.50
-31	2.63	-15	2.75
-16	2.88	-17	3.56

Weatherhead

Typical Application:

Hose support for long hose lengths. Also used to insure proper hose routing where abrasion, moving parts or heat may exist.

Material: C1010 steel with 1/32" thick black vinyl cushion.

Plating: Zinc-plated dichromate finish.

CLAMPING DIA.	CATALOG NUMBER	BOLT HOLE	CLAMPING DIA.	CATALOG NUMBER	BOLT HOLE
1/4	HK0509	1/4	1-1/8	HK1913	13/32
3/8	HK0709	9/32	1-3/16	HK2017	17/32
7/16	HK0809	9/32	1-1/4	HK2117	17/32
1/2	HK0913	13/32	1-3/8	HK2317	17/32
9/16	HK1013	13/32	1-1/2	HK2517	17/32
5/8	HK1113	13/32	1-9/16	HK2617	17/32
11/16	HK1213	13/32	1-3/4	HK2917	17/32
3/4	HK1313	13/32	1-7/8	HK3117	17/32
13/16	HK1413	13/32	1-15/16	HK3217	17/32
7/8	HK1513	13/32	2	HK3317	17/32
15/16	HK1613	13/32	2-5/32	HK3417	17/32
1	HK1713	13/32	2-21/32	HK3817	17/32
1-1/16	HK1813	13/32			

Accessories

Support Clamps

Heavy Duty Hose Support Clamps

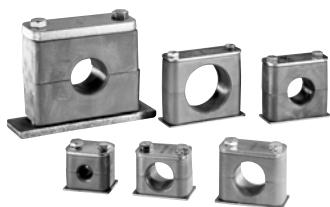

Part No. FF90311

These heavy duty weld-based clamps are designed to securely hold hose in applications subject to

impulsing, flexing and vibrating conditions. The clamps help prevent abrasion and extend hose life through

proper routing. Clamps are rated to ambient temperature of +250°F.

CLAMP PART NUMBER	INSIDE DIAMETER (MM)	INSIDE DIAMETER (IN.)	CLAMP PART NUMBER	INSIDE DIAMETER (MM)	INSIDE DIAMETER (IN.)
FF90311-127	12.70	0.50	FF90311-137	13.70	0.54
FF90311-150	15.00	0.59	FF90311-160	16.00	0.63
FF90311-171	17.10	0.67	FF90311-174	17.40	0.69
FF90311-190	19.00	0.75	FF90311-205	20.50	0.81
FF90311-222	22.20	0.87	FF90311-239	23.90	0.94
FF90311-254	25.40	1.00	FF90311-266	26.60	1.05
FF90311-280	28.00	1.10	FF90311-300	30.00	1.18
FF90311-320	32.00	1.26	FF90311-334	33.40	1.31
FF90311-357	35.70	1.41	FF90311-381	38.10	1.50
FF90311-400	40.00	1.57	FF90311-422	42.20	1.66
FF90311-445	44.50	1.75	FF90311-483	48.30	1.90
FF90311-508	50.80	2.00	FF90311-572	57.20	2.25
FF90311-635	63.50	2.50	FF90311-700	70.00	2.76

Accessories

Sleeving

Bundling Sleeves

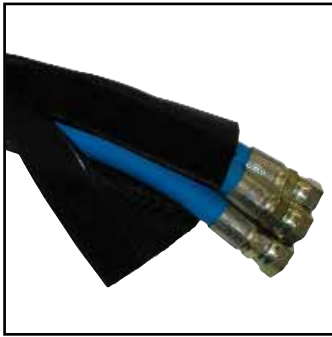

Specifications

PART NUMBER	FITS BUNDLE OUTER DIA.	CIRCUMFERENCE OF BUNDLE TO BE COVERED	SLEEVE WIDTH		BULK ROLL LENGTH	LENGTH TOLERANCE	FOR ORDERING: UNIT OF MEASURE
			LAI D FLAT IN.	FT.			
AQ	IN.	IN.					
FC676-2000	2.0	6	7 ¼	150	(+1 ft., - 0 ft)	Ft.	
FC676-3000	3.0	9.4	11	150	(+1 ft., - 0 ft)	Ft.	
FC676-4000	4.0	12.5	14	150	(+1 ft., - 0 ft)	Ft.	
FC676-5000	5.0	15.7	17 ¼	150	(+1 ft., - 0 ft)	Ft.	
FC676-6000	6.0	18.8	20 ¾	150	(+1 ft., - 0 ft)	Ft.	
WH							
A4926	2.0	6	7 ¼	150	(+1 ft., - 0 ft)	Ft.	
A4927	3.0	9.4	11	150	(+1 ft., - 0 ft)	Ft.	
A4928	4.0	12.5	14	150	(+1 ft., - 0 ft)	Ft.	
A4929	5.0	15.7	17 ¼	150	(+1 ft., - 0 ft)	Ft.	
A4930	6.0	18.8	20 ¾	150	(+1 ft., - 0 ft)	Ft.	

Hydraulic lines are subject to tremendous stress and wear in use. Lines that are allowed to move freely are easily abraded, crimped, or cut. But common methods for binding hydraulic lines, such as cable

ties, can restrict their movement too much as they expand and contract. We have the answer.

Our Bundling Sleeves hold lines securely in place to protect them from dam-

age, while providing enough flexibility for normal operation. The sleeves can be removed and replaced quickly, allowing easy access to individual hoses for repair.

Features

- Tight bundling and secure hose containment
- Choice of sizes and colors for visibility and aesthetics
- Resistant to heat, ozone, and abrasion
- Easy removal and replacement

Applications

- Case IH Patriot Sprayer SPX 4260 uses bundling sleeves to protect hydraulic and brake hoses
- Champion Road Machinery Sales uses bundling sleeves to protect hydraulic lines
- Rosco Manufacturing Company uses bundling sleeves on Model RA-200 Pothole Filler

Benefits

- Increases productivity in assembly and reassembly of hose bundles
- Reduces contamination of hoses during bundle assembly
- Forces routing of hydraulic lines for safety and efficiency
- Reduces risk of hose bursts, resulting in greater operator safety
- Reduces time spent on field repairs
- Replaces inefficient bundling methods and line-damaging cable ties
- Eliminates cumbersome winding of spiral formed products
- Reduces "old sock syndrome"—bunching at end of bundled lines
- Eliminates line contamination during hose replace-

Materials

- 1050 Ballistic Nylon, .71mm thickness

Coating

- Urethane

Color

- Black

Ambient Operating Temperature Range

- 175° F

How to order

Part numbers above are stocked in 150 ft. shrink wrapped bulk rolls as rolled up unfastened.

Orders should be for the number of rolls needed, not footage.

150 ft. bulk rolls will be one continuous length.

Accessories

Sleeving

Nylon Abrasion Sleeve

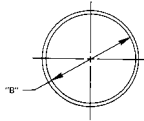

Aeroquip
Part No. FC425

Nylon sleeve protects hose from abrasion and allows bundling of hose lines.

Meets MSHA requirements.

Tech tips: 57% of hoses fail due to abrasion. Either re-route to avoid abrasion or use an abrasion sleeve.

PART NUMBER	NOMINAL SLEEVE I.D.* "B" (IN.)	PART NUMBER	NOMINAL SLEEVE I.D.* "B" (IN.)
FC425-12	.71	FC425-15	.92
FC425-16	1.00	FC425-18	1.13
FC425-20	1.25	FC425-24	1.59
FC425-28	1.75	FC425-32	2.07
FC425-38	2.38	FC425-40	2.54
FC425-46	2.86	FC425-54	3.34
FC425-59	3.66		

* The maximum O.D. of hose fittings must be allowed for if fittings are to be covered.

Weatherhead



MSHA Accepted ISO 6945

SLEEVE I.D.	.045" THIN WALL CATALOG NO.	.090" THICK WALL CATALOG NO.	PACKAGE * LENGTH (FT)	FLAT I.D. (IN.)
.90	A4900	A3900	100'	1.32-1.51
1.06	A4901	A3901	100'	1.57-1.76
1.22	A4902	A3902	100'	1.82-2.01
1.35	A4903	A3903	100'	2.03-2.21
1.66	A4904	A3904	100'	2.63-2.87
1.81	A4905	A3905	100'	2.75-2.94
2.19	A4906	A3906	100'	3.43-3.53
2.62	A4907	A3907	100'	4.02-4.21
2.80	A4908	A3908	100'	4.43-4.62

*Package contains two pieces that are not less than 30 feet long each.

A hose protection product used to help safeguard hose covers from abrasions and cuts. Typical areas of use include agricultural, logging, construction and mining

applications. The abrasion sleeve is also useful for bundling two or more hose assemblies together, in addition to the protective qualities the sleeving provides.

Available in .045" thin wall and .090" thick wall sleeving.

Material: Bulk continuous filament nylon.

Note: Wall thickness is for single wall.

Heat Sleeving

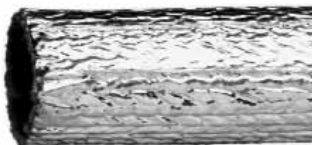

FF90356 REFLECTIVE HEAT SLEEVE	CROSS DIAMETER SIZE (IN.)	FOR GH134 -HOSE SIZE
FF90356-01	1.00	6 & 8
FF90356-02	1.25	10 & 12
FF90356-04	0.75	6
FF90356-05	0.62	4
FF90356-06	1.50	16

Designed for heat deflection of air conditioning hoses

Features and Benefits

- Wall thickness .025
- Protects from radiant heat to plus 400°C
- Nylon tie straps will hold in place (FF90349-22-150 for all sizes)
- 250 ft. rolls

Accessories

Bundling Straps

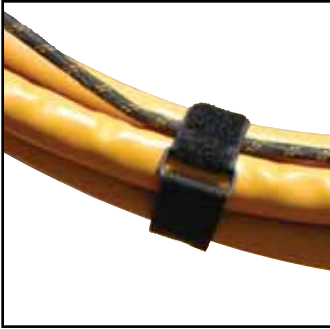

Merchandising kits for straps

STANDARD DUTY

PART NUMBER

FF13502

HEAVY DUTY

PART NUMBER

FF13503

Contains:

Each Merchandising kit comes complete with a quantity of individually cellophane wrapped, bundling straps in both Cinch and Hanging Styles for bundling diameters of 8", 12", 16" & 20" sizes (note the box will be stocked with approximately 1/2 of the available strap capacity to allow for lower kit pricing at start-up.) Re-supply merchandiser kit, by ordering the individually wrapped part numbers in the charts above.

The box is constructed to have a pop-up lid that can be positioned upright as an effective advertising backdrop. The box is shipped in a corrugated shipping container to prevent damage to the merchandising box.

Attached to the merchandising box by a wire lanyard, is a strap that can be used for demonstration

Bundling Straps hold hoses, cables, pipes, tubes and other items securely in place. They can be removed, adjusted and put back in place easily. The straps are made with a special hook-and-loop fastener developed for industrial applications, the safety industry and the military.

Unlike cable ties, Bundling Straps allow hoses and tubes to expand and contract in changing conditions. Cable ties must be destroyed when they are removed, but Bundling Straps can be used again and again with no loss of strength. The hook-and-loop fasteners used in Bundling Straps have superi-

or shear strength and peel compared to those used in the garment industry.

Cinching Strap (CS Series) Bundling Straps are designed for economical service applications, such as hose and cable bundling. All joints are ultrasonic welded and tested.

Hanging Strap (HS Series) Bundling Straps are held in place by a 3/8" grommet. The straps can be mounted vertically or horizontally.

Both cinching and hanging straps are available in standard duty or heavy duty. Heavy duty Bundling Straps are designed for severe industrial applications, rein-

forced with ballistic Cordura® nylon and ultrasonic welded to 1-1/2" hook-and-loop material. All heavy duty hardware is nickel-plated steel.

All Bundling Straps are in stock and ready for immediate shipment. They are sold in packages of 5, and discounts are available for volume quantities of 50, 100, 250, 500, and 1,000. Call to ask about special sizes, materials, colors or configurations.

Features

- Easy to remove and replace
- Adjustable to any size bundle
- Industrial strength strap fabric and fasteners
- Secure containment of hoses, cables and other items
- Clean, professional appearance

Benefits

- Reduces cost of managing cables and hoses
- Improves worker safety and productivity
- Reduces abrasion of bundled items
- Saves money through reusability

Materials

Standard Duty

- 1050 Ballistic Nylon, .71mm thickness with dense nylon backing.
- Standard Cinch and Hanging straps use a delrin fastening loop.

Heavy Duty

- 1050 Ballistic Nylon, 3.18mm thickness with dense nylon backing.
- Cinch and Hanging straps use a nickel plated steel fastening loop

Coating

- Urethane

Color

- Black

Ambient Operating Temperature Range

- 175° F



Accessories

Bundling Straps



Cinch Straps

STANDARD DUTY		HEAVY DUTY		CIRCUM. OF HOSE BUNDLE	STRAP LENGTH (FLAT)	ORDERING MEASUREMENT
BULK PACKED	INDIVIDUALLY CELLOPHANE WRAPPED	BULK PACKED	INDIVIDUALLY CELLOPHANE WRAPPED			
PART NUMBER	PART NUMBER	PART NUMBER	PART NUMBER	IN.	IN.	
FF90519-4	FF90520-4	FF90521-4	FF90522-4	4.0	7 ¼	Each
FF90519-6	FF90520-6	FF90521-6	FF90522-6	6.0	11	Each
FF90519-8	FF90520-8	FF90521-8	FF90522-8	8.0	14	Each
FF90519-10	FF90520-10	FF90521-10	FF90522-10	10.0	17 ¼	Each
FF90519-12	FF90520-12	FF90521-12	FF90522-12	12.0	20 ¾	Each
FF90519-14	FF90520-14	FF90521-14	FF90522-14	14.0		Each
FF90519-16	FF90520-16	FF90521-16	FF90522-16	16.0		Each
FF90519-18	FF90520-18	FF90521-18	FF90522-18	18.0		Each
FF90519-20	FF90520-20	FF90521-20	FF90522-20	20.0		Each
	FF90521-22	FF90522-22		22.0		Each
	FF90521-24	FF90522-24		24.0		Each
	FF90521-26	FF90522-26		26.0		Each

Hanging Straps

STANDARD DUTY		HEAVY DUTY		CIRCUM. OF HOSE BUNDLE	STRAP LENGTH (FLAT)	ORDERING MEASUREMENT
BULK PACKED	INDIVIDUALLY CELLOPHANE WRAPPED	BULK PACKED	INDIVIDUALLY CELLOPHANE WRAPPED			
PART NUMBER	PART NUMBER	PART NUMBER	PART NUMBER	IN.	IN.	
FF90523-4	FF90524-4	FF90525-4	FF90526-4	4.0	7 ¼	Each
FF90523-6	FF90524-6	FF90525-6	FF90526-6	6.0	11	Each
FF90523-8	FF90524-8	FF90525-8	FF90526-8	8.0	14	Each
FF90523-10	FF90524-10	FF90525-10	FF90526-10	10.0	17 ¼	Each
FF90523-12	FF90524-12	FF90525-12	FF90526-12	12.0	20 ¾	Each
FF90523-14	FF90524-14	FF90525-14	FF90526-14	14.0		Each
FF90523-16	FF90524-16	FF90525-16	FF90526-16	16.0		Each
FF90523-18	FF90524-18	FF90525-18	FF90526-18	18.0		Each
FF90523-20	FF90524-20	FF90525-20	FF90526-20	20.0		Each
		FF90525-22	FF90526-22	22.0		Each
		FF90525-24	FF90526-24	24.0		Each
		FF90525-26	FF90526-26	26.0		Each

Accessories

Protective Coils, Sleeves & Clamps

Steel Protective Coil Sleeve



Recommended for use where hose lines are subjected to excessive abrasion, kinking or accidental damage.

Construction: spring steel, rust resistant.

This coil should fit snugly to the hose O.D. expanding the coil I.D. (unwind the coil) may be necessary for proper installation.

Aeroquip Part No. 900705

SLEEVE DASH NO.	SLEEVE I.D. (IN.)	SLEEVE DASH NO.	SLEEVE I.D. (IN.)
-17S	.44	-1S	.50
-13S	.57	-2S	.63
-3S	.75	-4S	.88
-5S	1.03	-14S	1.13
-6S	1.22	-7S	1.47
-9S	1.69	-8S	1.91
-10S	2.13	-11S	2.56
-16S	2.44		

Flat Wire Spring Guard



Weatherhead Part No. A2900

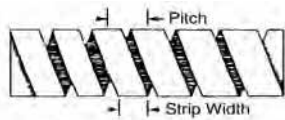

GUARD I.D.	CATALOG NUMBER	PKG LGTH (FT)	STRIP THICK	STRIP WIDTH	PITCH	GUARD I.D.	CATALOG NUMBER	PKG LGTH (FT)	STRIP THICK	STRIP WIDTH	PITCH
.515	A2900	100'	.028	.25	.37	1.110	A2909	100'	.028	.500	.69
.550	A2901	100'	.028	.25	.37	1.240	A2910	100'	.028	.500	.69
.610	A2902	100'	.028	.25	.37	1.300	A2911	60'	.028	.500	.69
.750	A2904	100'	.028	.25	.37	1.380	A2912	60'	.028	.500	.81
.835	A2905	100'	.028	.25	.37	1.630	A2913	60'	.028	.500	.81
.900	A2906	100'	.028	.500	.69	2.125	A2917	40'	.028	.500	.81
.990	A2907	100'	.028	.500	.69	2.300	A2919	40'	.028	.500	.81
1.055	A2908	100'	.028	.500	.69						

1/4" Width Galvanized Steel

Spring guards should be considered for those applications which call for tough, steel armor protection. They offer heavy-duty hose defense against cuts and abrasion, with the added

benefit of kink resistance and the ability to mold hose assembly routing for applications which require tight bends.

Accessories

Protective Coils, Sleeves & Clamps

Steel Protective Coil Spring

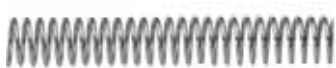

**Aeroquip Part No.
900564**

Protects hose cover and reinforcement from abrasion and accidental damage.

Construction: steel wire, rust resistant.

This coil should fit snugly to the hose O.D. expanding the coil I.D. (unwind the coil) may be necessary for proper installation.

SPRING DASH NO.	SPRING I.D. (IN.)	SPRING DASH NO.	SPRING I.D. (IN.)
-1S	.61	-12S	.67
-2S	.75	-15S	.81
-14S	.85	-3S	.91
-4S	1.04	-5S	1.18
-6S	1.34	-7S	1.66
-9S	1.87	-8S	2.13
-10S	2.38	-13S	2.75
-11S	2.88		

Round Wire Spring Guard

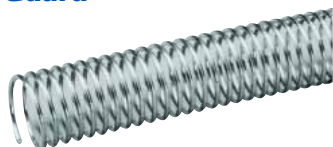

**Weatherhead Part No.
A1900**

GUARD I.D.	CATALOG NUMBER	PKG LGTH (FT)	WIRE DIA.	PITCH	GUARD I.D.	CATALOG NUMBER	PKG LGTH (FT)	WIRE DIA.	PITCH
.515	A1900	100'	.063	.188	.990	A1907-20	20'	.080	.188
.515	A1900-20	20'	.063	.188	1.055	A1908	100'	.080	.188
.550	A1901	100	.063	.188	1.055	A1908-20	20'	.080	.188
.550	A1901-20	20'	.063	.188	1.110	A1909	100'	.080	.250
.610	AS1902	100'	.063	.188	1.110	A1909-20	20'	.080	.250
.610	A1902-20	20'	.063	.188	1.240	A1910	100'	.080	.250
.650	A1903	100'	.080	.188	1.240	A1910-20	20'	.080	.250
.650	A1903-20	20'	.080	.188	1.300	A1911	60'	.120	.375
.750	A1904	100'	.080	.188	1.300	A1911-20	20'	.120	.375
.750	A1904-20	20'	.080	.188	1.380	A191	260'	.120	.375
.835	A1905	100'	.080	.188	1.630	A1913	60'	.120	.375
.835	A1905-20	20'	.080	.188	1.810	A1915	60'	.120	.375
.900	A1906	100'	.080	.188	2.000	A1916	40'	.120	.375
.900	A1906-20	20'	.080	.188	2.125	A1917	40'	.120	.375
.990	A1907	100'	.080	.188	2.300	A1919	40'	.120	.375

Accessories

Protective Coils, Sleeves & Clamps

Plastic Protective Coil Sleeve



Recommended to protect hose from abrasion, this light weight plastic sleeve is unaffected by air, water, oil,

gasoline, hydraulic and most other fluids.

This coil can also be used for group bundling of hose lines.

Temperature range of 0°F to +180°F.

Aeroquip Part No. 900952

SLEEVE DASH NO.	SLEEVE I.D. (IN.)	SLEEVE DASH NO.	SLEEVE I.D. (IN.)
-4	.25	-6	.38
-8	.50	-10	.63
-12	.75	-16	1.00
-22	1.38	-30	1.88

Firesleeve



Firesleeve will protect hose from direct flame. Firesleeve is constructed of a uniform single layer of braided fiber-

glass tubing impregnated with flame resistant silicone rubber.

Temperature range of -65°F to +500°F.

Aeroquip Part No. 624

PART NUMBER	I.D. (IN.)	CLAMP # (2 REQ'D)	PART NUMBER	I.D. (IN.)	CLAMP # (2 REQ'D)
624-5	.31	FF9217-0622S	624-7	.44	FF9217-0622S
624-8	.50	FF9217-0622S	624-9	.56	FF9217-0622S
624-10	.62	FF9217-0622S	624-11	.69	FF9217-0622S
624-12	.75	FF9217-0622S	624-13	.81	FF9217-0622S
624-14	.88	FF9217-0622S	624-16	1.00	FF9217-0622S
624-18	1.12	FF9217-0622S	624-20	1.25	FF9217-0648S
624-22	1.38	FF9217-0648S	624-24	1.50	FF9217-0648S
624-26	1.62	FF9217-0648S	624-28	1.75	FF9217-0648S
624-30	1.88	FF9217-0648S	624-32	2.00	FF9217-0648S
624-38	2.38	FF9217-0648S	624-42	2.62	FF9217-0648S
624-46	2.88	FF9217-0664C	624-50	3.12	FF9217-0664C
624-54	3.38	FF9217-0664C	624-60	3.75	FF9217-0664C

Accessories

Protective Coils, Sleeves & Clamps

Firesleeve Clamp



Recommended for attaching Firesleeve to hose lines.

Clamp numbers: FF9217-0622S, FF9217-0648S; 3/8 inch wide, FF9217-0664C; 1/2 inch wide.

Part No. FF9217

Firesleeve



Weatherhead Part No. A6900

SLEEVE I.D.	CATALOG NUMBER	ROLL LENGTH
.50	A6908	100'
.63	A6910	100'
.75	A6912	100'
.88	A6914	100'
1.00	A6916	100'
1.25	A6920	100'
1.50	A6924	100'
1.75	A6928	100'
2.00	A6932	50'
2.25	A6936	50'
2.50	A6940	50'
3.00	A6948	50'

Firesleeve is a flame-resistant sheathing constructed of tightly-woven fiberglass coated with a specially compounded, highly temperature-resistant, silicone rubber. Firesleeve offers you protection in hostile environments involving heat extremes. Not compatible with hydrocarbons.

Temperature Range:

Continuous exposure up to 500°F. Up to 2,000°F for 15-20 minutes. Up to 3,000°F for durations of 15-30 seconds.

Color: Red-Orange

Hose Accessories

AQ Selection Chart

PART #	STEEL PROT. COIL SPRING* 900564 (DASH SIZE)	PLASTIC COIL SLEEVE 900952 (DASH SIZE)	STEEL PROT. COIL SLEEVE* 900705 (DASH SIZE)	SUPPORT CLAMP 900729 (DASH SIZE)	INTERNAL SUPPORT COIL	NYLON SLEEVE* FC425 (DASH SIZE)	FIRE SLEEVE* 624 (DASH SIZE)	FIRE SLEEVE CLAMP FF9217 (DASH SIZE)	HEAVY DUTY SUPPORT CLAMP FF9031 (DASH SIZE)
302A16	-6S	-16	-6S	-27	222005-14C	-24	-24	-0648S	-320
302A20	-7S	-22	-7S	-10	222005-15C	-28	-30	-0648S	-381
302A24	-9S	-22	-9S	-12	222005-17C	-32	-32	-0648S	-445
302A32	-10S	-30	-10S	-14	222005-18C	-38	-38	-0648S	-572
303-4	-1S	-6	-1S	-1		-12	-11	-0622S	-127
303-5	-12S	-8	-13S	-2		-12	-12	-0622S	-150
303-6	-2S	-10	-2S	-21		-16	-14	-0622S	-174
303-8	-14S	-12	-3S	-4	222005-10C	-16	-16	-0622S	-190
303-10	-4S	-12	-4S	-6	222005-21C	-20	-18	-0630S	-239
303-12	-5S	-16	-5S	-8	222005-13C	-20	-20	-0630S	-280
1503-4	-1S	-6	-1S	-1		-12	-11	-0622S	-137
1503-5	-12S	-8	-13S	-2		-12	-12	-0622S	
1503-6	-2S	-10	-2S	-21		-16	-14	-0622S	-174
1503-8	-14S	-12	-3S	-4	222005-10C	-16	-16	-0622S	-190
1503-10	-4S	-12	-4S	-6	222005-21C	-20	-18	-0630S	-239
1503-12	-5S	-16	-5S	-8	222005-13C	-20	-20	-0630S	-280
1503-16	-6S	-16	-6S	-27	222005-14C	-24	-24	-0648S	-320
1503-20	-7S	-22	-7S	-10	222005-15C	-28	-30	-0648S	-381
1503-24	-9S	-22	-9S	-12	222005-17C	-32	-32	-0648S	-445
1503-32	-10S	-30	-10S	-14	222005-18C	-38	-38	-0648S	-572
1503-40			-12S	-16	222005-19C				
1531-10	-4S	-12	-4S	-6		-20	-16	-0622S	-239
1531-12	-5S	-16	-5S	-8		-20	-20	-0630S	-280
1531-16	-7S	-16	-6S	-25		-24	-24	-0630S	-357
1531-20	-7S	-22	-7S	-10		-28	-30	-0648S	-422
1531A-24	-6S	-16	-5S	-9		-24	-32	-0648S	-483
2550-6	-14S	-10	-3S	-4		-16	-13	-0622S	-174
2554-6	-14S	-10	-2S	-4		-16	-13	-0622S	-174
2555-6	-14S	-10	-2S	-4		-16	-13	-0622S	-190
2556-4	-1S	-6	-1S	-1		-12	-9	-0622S	-127
2556-6	-12S	-8	-13S	-21		-16	-11	-0622S	-160
2556-8	-14S	-10	-3S	-4		-16	-13	-0622S	-190
2556-10	-4S	-12	-4S	-5		-16	-16	-0622S	-222
2556-12	-5S	-16	-5S	-23		-20	-18	-0630S	-266
2565-4	-1S	-6	-1S	-1		-12	-9	-0622S	-127
2565-6	-12S	-8	-13S	-21		-16	-11	-0622S	-160
2565-8	-14S	-10	-3S	-4		-16	-13	-0622S	-205
2565-10	-4S	-12	-4S	-6		-16	-16	-0622S	-239
2565-12	-5S	-16	-5S	-8		-20	-18	-0630S	-280
2570-6	-14S	-10	-3S	-4		-16	-13	-0622S	-174
2570-8	-4S	-12	-4S	-6	222005-11C	-16	-18	-0622S	-190
2570-10	-5S	-16	-5S	-8	222005-13C	-20	-20	-0648S	-239
2575-4	-1S	-6	-1S	-1		-12	-9	-0622S	-127

*Sizes indicated are based on Hose O.D. only. If sleeve is to be placed over fittings, a larger sleeve size may be required, depending on type of fitting used.

Hose Accessories

AQ Selection Chart

PART #	STEEL PROT. COIL SPRING* 900564 (DASH SIZE)	PLASTIC COIL SLEEVE 900952 (DASH SIZE)	STEEL PROT. COIL SLEEVE* 900705 (DASH SIZE)	SUPPORT CLAMP 900729 (DASH SIZE)	INTERNAL SUPPORT COIL	NYLON SLEEVE* FC425 (DASH SIZE)	FIRESLEEVE* 624 (DASH SIZE)	FIRESLEEVE CLAMP FF9217 (DASH SIZE)	HEAVY DUTY SUPPORT CLAMP FF9031 (DASH SIZE)
2575-6	-12S	-8	-13S	-21		-16	-11	-0622S	-160
2575-8	-14S	-10	-3S	-4		-16	-13	-0622S	-190
2575-10	-4S	-12	-4S	-6		-20	-16	-0622S	-222
2575-12	-5S	-16	-5S	-23		-20	-18	-0630S	-266
2580-4	-1S	-6	-1S	-1		-12	-11	-0622S	-127
2580-5	-12S	-8	-13S	-2		-12	-12	-0622S	-150
2580-6	-2S	-10	-2S	-21		-16	-14	-0622S	-174
2580-8	-14S	-12	-3S	-4	222005-10C	-16	-16	-0622S	-190
2580-10	-4S	-12	-4S	-6	222005-21C	-20	-18	-0630S	-239
2580-12	-5S	-16	-5S	-8	222005-13C	-20	-20	-0630S	-280
2580-16	-6S	-16	-6S	-27	222005-14C	-24	-24	-0648S	-320
2580-20	-7S	-22	-7S	-10	222005-15C	-28	-28	-0648S	-381
2580-24	-9S	-22	-9S	-12	222005-17C	-32	-32	-0648S	-445
2580-32	-10S	-30	-10S	-14	222005-18C	-40	-42	-0648S	-572
2583-4	-1S	-8	-1S	-2		-12	-11	-0622S	-150
2583-6	-14S	-10	-3S	-4		-16	-16	-0622S	-190
2583-8	-4S	-12	-4S	-6		-20	-20	-0648S	-239
2583-12	-6S	-16	-14S	-24		-24	-24	-0648S	-320
2583-16	-7S	-22	-7S	-10		-28	-28	-0648S	-381
2583-20	-8S	-22	-9S	-12		-32	-32	-0648S	-445
2651-4	-1S	-6	-1S	-1		-12	-11	-0622S	-137
2651-5	-12S	-8	-13S	-2		-12	-12	-0622S	
2651-6	-2S	-10	-2S	-21		-16	-14	-0622S	-174
2651-8	-14S	-12	-3S	-4	222005-10C	-16	-16	-0622S	-190
2651-10	-4S	-12	-4S	-6	222005-21C	-20	-18	-0630S	-239
2651-12	-5S	-16	-5S	-8	222005-13C	-20	-20	-0630S	-280
2651-16	-6S	-16	-6S	-27	222005-14C	-24	-24	-0648S	-320
2651-20	-7S	-22	-7S	-10	222005-15C	-28	-30	-0648S	-381
2651-24	-9S	-22	-9S	-12	222005-17C	-32	-32	-0648S	-445
2651-32	-10S	-30	-10S	-14	222005-18C	-38	-42	-0648S	-572
2651-40			-12S	-16	222005-19C	-54	-50	-0664C	
2661-12	-6S	-16	-14S	-24		-24	-24	-0630S	-320
2661-16	-7S	-22	-7S	-10		-28	-28	-0648S	-381
2661-20	-8S	-22	-9S	-12		-32	-32	-0648S	-445
2661-24	-10S	-30	-15S	-29		-38	-38	-0648S	-508
2661-32	-13S		-16S	-30		-46	-46	-0664C	-635
2661-40						-54	-54	-0664C	
2661-48							-60		
2661-64									
2681-3	-1S	-6	-1S	-1		-12	-11	-0622S	
2681-4	-12S	-8	-13S	-21		-16	-12	-0622S	-160
2681-5	-2S	-8	-2S	-3		-16	-14	-0630S	
2681-6	-14S	-10	-3S	-4		-16	-18	-0630S	-205

*Sizes indicated are based on Hose O.D. only. If sleeve is to be placed over fittings, a larger sleeve size may be required, depending on type of fitting used.

Hose Accessories

AQ Selection Chart

PART #	STEEL PROT. COIL SPRING* 900564 (DASH SIZE)	PLASTIC COIL SLEEVE 900952 (DASH SIZE)	STEEL PROT. COIL SLEEVE* 900705 (DASH SIZE)	SUPPORT CLAMP 900729 (DASH SIZE)	INTERNAL SUPPORT COIL	NYLON SLEEVE* FC425 (DASH SIZE)	FIRESLEEVE* 624 (DASH SIZE)	FIRESLEEVE CLAMP FF9217 (DASH SIZE)	HEAVY DUTY SUPPORT CLAMP FF9031 (DASH SIZE)
2681-8	-4S	-12	-4S	-5		-20	-20	-0630S	-222
2681-10	-5S	-12	-5S	-23		-20	-20	-0630S	-266
2681-12	-6S	-16	-14S	-27	222005-14C	-24	-22	-0648S	-300
2681-16	-7S	-22	-7S	-10	222005-15C	-28	-28	-0648S	-381
2681-20	-8S	-22	-9S	-28	222005-17C	-32	-38	-0648S	-445
2681-24	-10S	-30	-15S	-29	222005-18C	-38	-38	-0648S	-508
2681-32	-13S	-30	-11S	-31	222005-19C	-46	-46	-0664C	-635
2781-4	-2S	-8	-2S	-3		-16	-14	-0622S	-174
2781-6	-3S	-12	-3S	-5		-16	-16	-0630S	-222
2781-8	-4S	-12	-4S	-6		-20	-18	-0630S	-239
2781-10	-5S	-16	-5S	-8		-20	-20	-0630S	-280
2781-12	-6S	-16	-6S	-24		-24	-26	-0648S	-320
2781-16	-7S	-22	-7S	-11		-28	-30	-0648S	-400
2781-20	-8S	-30	-8S	-13		-38	-38	-0648S	-508
2781-24	-10S	-30	-10S	-14		-40	-42	-0648S	-572
2781-32	-11S	-30	-11S	-15		-54	-46	-0664C	-700
2807-3		-4		-18			-7	-0622S	
2807-4		-4		-18			-8	-0622S	
2807-5		-4		-19			-9	-0622S	
2807-6		-6	-17S	-01	222005-23C		-10	-0622S	
2807-8	-1S	-8	-1S	-1	222005-10C	-12	-12	-0622S	-137
2807-10	-2S	-8	-3S	-21	222005-21C	-16	-14	-0630S	-160
2807-12	-2S	-10	-3S	-4	222005-13C	-16	-16	-0630S	-190
2807-16	-3S	-12	-5S	-23	222005-14C	-20	-20	-0630S	-266
2807-20	-5S	-16	-6S	-24	222005-15C	-24	-24	-0648S	-320
2808-8	-12S	-6	-1S	-2	222005-10C	-12	-16	-0622S	-150
2808-10	-2S	-8	-2S	-3	222005-21C	-16	-18	-0630S	-174
2808-12	-14S	-10	-3S	-5	222005-13C	-16	-20	-0630S	-205
2808-16	-5S	-16	-5S	-8	222005-14C	-20	-26	-0648S	-280
2808-20	-7S	-16	-6S	-25	222005-15C	-24	-32	-0648S	-334
2808-24	-7S	-22	-7S	-11	222005-17C	-28	-38	-0648S	-422
CR170-4	-1S	-6	-1S	-1		-12	-11	-0622S	
CR170-6	-2S	-10	-2S	-21		-16	-14	-0622S	
CR170-8	-14S	-12	-3S	-4	222005-10C	-16	-16	-0622S	
FC136-06	-3S	-12	-3S	-5		-16	-16	-0630S	-205
FC136-08	-4S	-12	-4S	-6		-20	-18	-0630S	-239
FC136-10	-5S	-16	-5S	-8		-20	-20	-0630S	-280
FC136-12	-6S	-16	-6S	-24		-24	-26	-0630S	-300
FC136-16	-7S	-22	-7S	-11		-28	-28	-0630S	-381
FC136-20	-8S	-22	-8S	-28		-32	-38	-0648S	
FC136-24	-10S	-30	-10S	-29		-38	-38	-0648S	
FC136-32	-13S	-30	-11S	-31		-46	-46	-0664C	

*Sizes indicated are based on Hose O.D. only. If sleeve is to be placed over fittings, a larger sleeve size may be required, depending on type of fitting used.

Hose Accessories

AQ Selection Chart

PART #	STEEL PROT. COIL SPRING* 900564 (DASH SIZE)	PLASTIC COIL SLEEVE 900952 (DASH SIZE)	STEEL PROT. COIL SLEEVE* 900705 (DASH SIZE)	SUPPORT CLAMP 900729 (DASH SIZE)	INTERNAL SUPPORT COIL	NYLON SLEEVE* FC425 (DASH SIZE)	FIRESLEEVE* 624 (DASH SIZE)	FIRESLEEVE CLAMP FF9217 (DASH SIZE)	HEAVY DUTY SUPPORT CLAMP FF9031 (DASH SIZE)
FC194-04	-12S	-8	-13S	-21		-16	-12	-0622S	-160
FC194-06	-14S	-10	-3S	-4		-16	-18	-0622S	-205
FC194-08	-4S	-12	-4S	-5		-20	-20	-0630S	-222
FC194-10	-5S	-12	-5S	-23		-20	-20	-0630S	-266
FC194-12	-6S	-16	-14S	-27		-24	-22	-0648S	-300
FC194-16	-7S	-22	-7S	-10		-28	-26	-0648S	-381
FC194-20	-8S	-22	-9S	-28		-32	-32	-0648S	-445
FC195-04	-2S	-8	-2S	-3		-16	-14	-0622S	-174
FC195-06	-3S	-12	-3S	-5		-16	-16	-0622S	-222
FC195-08	-4S	-12	-4S	-6		-20	-18	-0630S	-239
FC195-10	-5S	-16	-5S	-8		-20	-20	-0630S	-280
FC195-12	-6S	-16	-6S	-24		-24	-26	-0630S	-320
FC195-16	-7S	-22	-7S	-11		-28	-30	-0648S	-400
FC195-20	-8S	-30	-8S	-13		-38	-38	-0648S	-500
FC195-24	-10S	-30	-10S	-14		-38	-42	-0648S	-572
FC195-32	-11S	-30	-11S	-15		-54	-46	-0648S	-700
FC211-04	-1S	-6	-1S	-1		-12	-11	-0622S	-137
FC211-06	-15S	-10	-2S	-3		-16	-14	-0622S	-174
FC211-08	-3S	-10	-3S	-5		-16	-16	-0630S	-205
FC211-12	-5S	-16	-5S	-8		-24	-24	-0630S	-280
FC211-16	-7S	-22	-6S	-25		-24	-24	-0648S	-357
FC212-04	-12S	-8	-13S	-2		-12	-12	-0622S	-150
FC212-06	-14S	-10	-2S	-4		-16	-14	-0630S	-190
FC212-08	-3S	-12	-4S	-5		-16	-18	-0630S	-222
FC212-12	-6S	-16	-14S	-9		-20	-22	-0648S	-300
FC212-16	-7S	-22	-7S	-10		-24	-26	-0648S	-381
FC212-20	-8S	-22	-8S	-28		-32	-32	-0648S	-483
FC212-24	-10S	-30	-10S	-13	222005-18C	-38	-38	-0648S	
FC212-32	-13S	-30	-12S	-30	222005-19C	-46	-46	-0664C	-635
FC234-05	-1S	-10	-2S	-21		-12	-11	-0622S	-150
FC234-06	-2S	-12	-3S	-4		-12	-12	-0622S	-174
FC234-08	-3S	-12	-4S	-4	222005-10C	-16	-12	-0622S	-190
FC234-10	-4S	-16	-5S	-23	222005-21C	-16	-13	-0622S	-239
FC234-12	-5S	-16	-14S	-9	222005-13C	-20	-16	-0630S	-280
FC234-16	-6S	-22	-7S	-24	222005-14C	-20	-20	-0630S	-320
FC252-08									-205
FC252-10									-239
FC252-12									-266
FC252-16									-334
FC 254-08	-4S	-12	-4S	-6		-20	-18	-0630S	-254
FC254-12	-6S	-16	-6S	-24		-24	-26	-0648S	-320
FC254-16	-7S	-22	-7S	-10		-28	-30	-0648S	-381

*Sizes indicated are based on Hose O.D. only. If sleeve is to be placed over fittings, a larger sleeve size may be required, depending on type of fitting used.

Hose Accessories

AQ Selection Chart

PART #	STEEL PROT. COIL SPRING* 900564 (DASH SIZE)	PLASTIC COIL SLEEVE 900952 (DASH SIZE)	STEEL PROT. COIL SLEEVE* 900705 (DASH SIZE)	SUPPORT CLAMP 900729 (DASH SIZE)	INTERNAL SUPPORT COIL	NYLON SLEEVE* FC425 (DASH SIZE)	FIRESLEEVE* 624 (DASH SIZE)	FIRESLEEVE CLAMP FF9217 (DASH SIZE)	HEAVY DUTY SUPPORT CLAMP FF9031 (DASH SIZE)
FC254-20	-8S	-22	-9S	-28		-32	-32	-0648S	-445
FC254-24	-10S	-30	-10S	-29		-38	-38	-0648S	
FC254-32	-10S	-30	-11S	-31		-54	-46	-0664C	-700
FC273-12	-6S	-16	-6S	-24		-24	-26	-0648S	-320
FC273-16	-7S	-22	-7S	-10		-28	-30	-0648S	-381
FC273-20	-8S	-30	-8S	-13		-38	-38	-0648S	-508
FC273-24	-10S	-30	-10S	-14		-40	-42	-0664C	-572
FC273-32	-11S			-16		-54	-46	-0664C	-700
FC300-04	-1S	-6	-1S	-1		-12	-11	-0622S	-137
FC300-05	-12S	-8	-13S	-2		-12	-12	-0622S	
FC300-06	-2S	-10	-2S	-21		-16	-14	-0622S	-174
FC300-08	-14S	-12	-3S	-4	222005-10C	-16	-16	-0622S	-190
FC300-10	-4S	-12	-4S	-6	222005-21C	-20	-18	-0630S	-239
FC300-12	-5S	-16	-5S	-8	222005-13C	-20	-20	-0630S	-280
FC300-16	-6S	-16	-6S	-27	222005-14C	-24	-24	-0648S	-320
FC300-20	-7S	-22	-7S	-10	222005-15C	-28	-30	-0648S	-381
FC300-24	-9S	-22	-9S	-12	222005-17C	-32	-32	-0648S	-445
FC300-32	-10S	-30	-10S	-14	222005-18C	-38	-38	-0648S	-572
FC300-40			-12S	-16	222005-19C				
FC310-04	-12S	-6	-1S	-2		-12	-12	-0622S	-137
FC310-06	-14S	-10	-2S	-4		-12	-16	-0622S	-174
FC310-08	-3S	-12	-3S	-5		-16	-16	-0630S	-205
FC310-10	-4S	-12	-4S	-6		-20	-18	-0630S	-239
FC310-12	-5S	-16	-5S	-8		-20	-22	-0630S	-280
FC310-16	-7S	-16	-6S	-25		-24	-24	-0648S	-357
FC310-20	-9S	-30	-8S	-12		-32	-30	-0648S	-422
FC318-12	-6S	-16	-14s	-24		-24	-24	-0630S	-320
FC321-04	-1S	-6	-1S	-1		-12	-11	-0622S	-137
FC321-05	-12S	-8	-13S	-2		-12	-12	-0622S	-150
FC321-06	-2S	-10	-2S	-21		-16	-14	-0622S	-174
FC321-08	-14S	-12	-3S	-4	222005-10C	-16	-16	-0622S	-190
FC321-10	-4S	-12	-4S	-5	222005-11C	-20	-18	-0630S	-239
FC321-12	-5S	-16	-5S	-8	222005-13C	-20	-20	-0630S	-280
FC321-16	-6S	-16	-6S	-27	222005-14C	-24	-22	-0630S	-320
FC323-12	-5S	-16	-14S	-27		-24	-24	-0643S	-300
FC323-16	-6S	-22	-7S	-25		-28	-28	-0643S	-381
FC323-20	-8S	-30	-15S	-28		-32	-32	-0648S	
FC323-24	-10S	-30	-10S	-29		-38	-38	-0648S	
FC323-32	-13S	-30	-11S	-31		-46	-46	-0664C	
FC324-08	-4S	-12	-4S	-6		-20	-18	-0622S	-239
FC324-12	-6S	-16	-14S	-27		-24	-26	-0648S	-300
FC324-16	-7S	-22	-7S	-10		-28	-30	-0648S	-381

*Sizes indicated are based on Hose O.D. only. If sleeve is to be placed over fittings, a larger sleeve size may be required, depending on type of fitting used.

Hose Accessories

AQ Selection Chart

PART #	STEEL PROT. COIL SPRING* 900564 (DASH SIZE)	PLASTIC COIL SLEEVE 900952 (DASH SIZE)	STEEL PROT. COIL SLEEVE* 900705 (DASH SIZE)	SUPPORT CLAMP 900729 (DASH SIZE)	INTERNAL SUPPORT COIL	NYLON SLEEVE* FC425 (DASH SIZE)	FIRESLEEVE* 624 (DASH SIZE)	FIRESLEEVE CLAMP FF9217 (DASH SIZE)	HEAVY DUTY SUPPORT CLAMP FF9031 (DASH SIZE)
FC325-12	-6S	-16	-6S	-24		-24	-26	-0648S	-320
FC325-16	-7S	-22	-7S	-10		-28	-30	-0648S	-381
FC332-04	-1S	-6	-1S			-12	-9	-0622S	-127
FC332-06	-12S	-8	-13S	-21		-16	-11	-0622S	-160
FC332-08	-14S	-10	-3S	-4		-16	-13	-0622S	-190
FC332-10	-3S	-12	-4S	-5		-20	-16	-0622S	-222
FC332-12	-5S	-12	-5S	-23		-20	-18	-0630S	-266
FC350-04	-1S	-6	-1S	-1		-12	-11	-0622S	-127
FC350-05	-12S	-8	-13S	-2		-12	-12	-0622S	-150
FC350-06	-2S	-10	-2S	-21		-16	-14	-0622S	-174
FC350-08	-14S	-12	-3S	-4	222005-10C	-16	-16	-0622S	-190
FC350-10	-4S	-12	-4S	-6	222005-21C	-20	-18	-0630S	-239
FC350-12	-16S	-5	-5S	-8	222005-13C	-20	-20	-0630S	-280
FC350-16	-6S	-16	-6S	-27	222005-14C	-24	-24	-0648S	-320
FC350-20	-7S	-22	-7S	-10	222005-15C	-28	-30	-0648S	-381
FC350-24	-9S	-22	-9S	-12	222005-17C	-32	-32	-0648S	-445
FC352-08									-239
FC352-10									-266
FC352-12									-300
FC352-14									-334
FC352-16									-357
FC352-18									-400
FC352-20									-422
FC352-22									-445
FC352-24									-508
FC352-26									-508
FC352-28									-572
FC352-32									-635
FC352-36									-700
FC352-38									
FC352-40									
FC352-44									
FC352-48									
FC352-56									
FC352-64									
FC355-04	-1S	-6	-1S	-1		-12	-11	-0622S	-127
FC355-05	-1S	-6	-2S	-1		-12	-11	-0622S	-150
FC355-06	-12S	-8	-1S	-2		-12	-12	-0622S	-174
FC355-08	-2S	-10	-13S	-3		-16	-12	-0622S	-190
FC355-10	-3S	-12	-3S	-5	222005-10C	-16	-13	-0622S	-239
FC355-12	-4S	-6	-5S-4S	-6	222005-21C	-20	-16	-0630S	-280
FC355-16	-5S	-16	-6S	-9	222005-13C	-20	-20	-0630S	-320

*Sizes indicated are based on Hose O.D. only. If sleeve is to be placed over fittings, a larger sleeve size may be required, depending on type of fitting used.

Hose Accessories

AQ Selection Chart

PART #	STEEL PROT. COIL SPRING* 900564 (DASH SIZE)	PLASTIC COIL SLEEVE 900952 (DASH SIZE)	STEEL PROT. COIL SLEEVE* 900705 (DASH SIZE)	SUPPORT CLAMP 900729 (DASH SIZE)	INTERNAL SUPPORT COIL	NYLON SLEEVE* FC425 (DASH SIZE)	FIRESLEEVE* 624 (DASH SIZE)	FIRESLEEVE CLAMP FF9217 (DASH SIZE)	HEAVY DUTY SUPPORT CLAMP FF9031 (DASH SIZE)
FC355-20	-6S	-22	-7S	-24	222005-14C	-24	-22	-0648S	-381
FC355-24	-7S	-22	-7S	-10	222005-15C	-28	-30	-0648S	-445
FC355-32	-9S	-22	-9S	-12	222005-17C	-32	-32	-0648S	-572
FC363-08	-15S	-10	-4S	-5		-16	-14	-0622S	-190
FC363-12	-5S	-16	-6S	-8		-20	-20	-0630S	-266
FC363-16	-6S	-16	-7S	-10		-24	-22	-0630S	-320
FC363-20	-7S	-22	-9S	-11		-28	-26	-0648S	-381
FC363-24	-9S	-22	-8S	-2S		-32	-30	-0648S	-445
FC363-32	-10S		-16S	-30		-59	-42	-0648S	-572
FC364-08	-15S	-10	-4S	-5		-16	-14	-0622S	-190
FC364-12	-5S	-16	-6S	-8		-20	-20	-0630S	-266
FC364-16	-6S	-22	-7S	-10		-24	-22	-0630S	-320
FC364-20	-7S	-30	-9S	-11		-28	-26	-0648S	-381
FC364-24	-9S	-30	-8S	-28		-32	-30	-0648S	-445
FC364-32	-10S		-16S	-30		-59	-42	-0648S	-572
FC364-40	-11S	-30	-12S	-16		-54	-50	-0664S	-635
FC364-48									
FC465-03		-4		-18			-9	-0622S	
FC465-04		-4		-18			-9	-0622S	
FC465-05		-4		-19			-10	-0622S	
FC465-06		-6		-01	222005-23C	-12	-11	-0622S	
FC465-08	-1S	-8	-1S	-1	222005-10C	-12	-13	-0622S	-137
FC465-10	-1S	-8	-13S	-21	222005-21C	-16	-14	-0622S	-160
FC465-12	-2S	-10	-3S	-4	222005-13C	-16	-16	-0622S	-190
FC465-16	-3S	-12	-5S	-23	222005-14C	-20	-20	-0648S	-266
FC465-20	-5S	-16	-6S	-24	222005-15C	-24	-24	-0648S	-320
FC466-04	-1S	-6	-1S	-1		-12	-9	-0622S	-127
FC466-06	-12S	-8	-13S	-21		-16	-11	-0622S	-160
FC466-08	-14S	-10	-3S	-4		-16	-13	-0622S	-190
FC466-10	-3S	-12	-4S	-5		-20	-16	-0622S	-222
FC466-12	-5S	-12	-5S	-23		-20	-18	-0630S	-266
FC469-06	-1S	-6	-1S	-1	222005-23C	-12	-12	-0622S	
FC469-08	-1S	-8	-13S	-21	222005-10C	-16	-14	-0622S	
FC469-10	-12S	-10	-2S	-4	222005-21C	-16	-16	-0622S	-150
FC498-04	-1S	-6	-1S	-1		-12	-9	-0622S	-127
FC498-06	-12S	-8	-13S	-21		-16	-11	-0622S	-160
FC498-08	-14S	-10	-3S	-4		-16	-13	-0622S	-190
FC498-10	-4S	-12	-4S	-5		-20	-16	-0622S	-222
FC498-12	-5S	-12	-5S	-23		-20	-18	-0630S	-266
FC510-04	-12S	-6	-1S	-2		-12	-12	-0622S	
FC510-06	-14S	-10	-2S	-4		-16	-16	-0622S	-174
FC510-08	-3S	-12	-3S	-5		-16	-16	-0630S	-205

*Sizes indicated are based on Hose O.D. only. If sleeve is to be placed over fittings, a larger sleeve size may be required, depending on type of fitting used.

Hose Accessories

AQ Selection Chart

PART #	STEEL PROT. COIL SPRING* 900564 (DASH SIZE)	PLASTIC COIL SLEEVE 900952 (DASH SIZE)	STEEL PROT. COIL SLEEVE* 900705 (DASH SIZE)	SUPPORT CLAMP 900729 (DASH SIZE)	INTERNAL SUPPORT COIL	NYLON SLEEVE* FC425 (DASH SIZE)	FIRESLEEVE* 624 (DASH SIZE)	FIRESLEEVE CLAMP FF9217 (DASH SIZE)	HEAVY DUTY SUPPORT CLAMP FF9031 (DASH SIZE)
FC510-10	-4S	-12	-4S	-6		-20	-18	-0630S	-239
FC510-12	-5S	-16	-5S	-8		-20	-22	-0630S	-280
FC510-16	-7S	-16	-6S	-25		-24	-24	-0630S	-334
FC510-20	-9S	-30	-8S	-12		-32	-30	-0648S	-422
FC563-08	-15S	-12	-3S	-5		-16	-16	-0622S	-205
FC563-12	-5S	-16	-14S	-9		-20	-22	-0648S	-280
FC563-16	-6S	-16	-6S	-2S		-24	-26	-0648S	-334
FC563-20	-7S	-22	-7S	-11		-28	-30	-0648S	
FC563-24	-9S	-22	-9S	-28		-32	-32	-0648S	
FC563-32	-10S	-30	-10S	-14		-40	-42	-0648S	
FC579-04	-2S	-8	-2S	-3		-16	-14	-0622S	-174
FC606-16	-7S	-22	-7S	-10	222005-15C	-28	-30	-0648S	-422
FC606-20	-8S	-30	-8S	-13	222005-17C	-38	-38	-0648S	-508
FC606-24	-10S	-30	-10S	-14	222005-18C	-40	-42	-0648S	-572
FC611-04	-1S	-6	-1S	-1		-12	-11	-0622S	-137
FC611-06	-15S	-10	-2S	-3		-16	-14	-0622S	-174
FC611-08	-3S	-10	-3S	-5		-16	-16	-0630S	-205
FC611-12	-5S	-16	-5S	-8		-24	-24	-0630S	-280
FC611-16	-7S	-22	-6S	-25		-24	-24	-0648S	-357
FC611-20	-9S	-30	-8S	-12		-32	-30	-0648S	-422
FC611-24	-8S	-30	-8S	-13		-38	-38	-0648S	-483
FC611-32	-13S	-30	-12S	-30	222005-19C	-46	-46	-0664C	-635
FC619-12	-6S	-16	-6S	-27		-24	-26	-0648S	-300
FC619-16	-6S	-22	-7S	-25		-28	-28	-0643S	-381
FC619-20	-8S	-22	-9S	-12		-32	-32	-0648S	-445
FC619-24	-10S	-30	-15S	-29		-38	-38	-0648S	-508
FC619-32	-13S		-16S	-30		-46	-46	-0664C	-635
FC636-12	-5S	-16	-14S	-27		-24	-24	0643S	-300
FC636-16	-6S	-22	-7S	-25		-28	-28	-0643S	-381
FC636-20	-8S	-22	-10S	-28	222005-17C	-32	-38	-0648S	
FC636-24	-8S	-30	-10S	-29	222005-18C	-38	-38	-0648S	
FC639-04	-1S	-6	-1S	-1		-12	-11	-0622S	-137
FC639-06	-2S	-10	-2S	-3		-16	-14	-0622S	-174
FC639-08	-15S	-10	-3S	-5		-16	-16	-0622S	-205
FC639-10	-54S	-16	-5S	-6		-20	-20	-0630S	-239
FC639-12	-5S	-16	-6S	-9	222005-14C	-22	-22	-0648S	-280
FC639-16	-7S	-22	-7S	-10	222005-15C	-24	-28	-0648S	-357
FC645-06		-6	-17S	-01	222005-23C		-10	-0622S	
FC647-04	-1S	-6	-1S	-1		-12	-9	-0622S	-127
FC647-06	-12S	-8	-13S	-21		-16	-11	-0622S	-160
FC647-08	-14S	-10	-3S	-4		-16	-13	-0622S	-190
FC647-10	-3S	-12	-4S	-5		-20	-16	-0622S	-222

*Sizes indicated are based on Hose O.D. only. If sleeve is to be placed over fittings, a larger sleeve size may be required, depending on type of fitting used.

Hose Accessories

AQ Selection Chart

PART #	STEEL PROT. COIL SPRING* 900564 (DASH SIZE)	PLASTIC COIL SLEEVE 900952 (DASH SIZE)	STEEL PROT. COIL SLEEVE* 900705 (DASH SIZE)	SUPPORT CLAMP 900729 (DASH SIZE)	INTERNAL SUPPORT COIL	NYLON SLEEVE* FC425 (DASH SIZE)	FIRE SLEEVE* 624 (DASH SIZE)	FIRE SLEEVE CLAMP FF9217 (DASH SIZE)	HEAVY DUTY SUPPORT CLAMP FF9031 (DASH SIZE)
FC647-12	-5S	-12	-5S	-23		-20	-18	-0630S	-266
FC650-04	-1S	-6	-1S	-1		-12	-11	-0622S	
FC650-06	-2S	-10	-2S	-21		-16	-14	-0622S	-160
FC650-08	-14S	-12	-3S	-4	222005-10C	-16	-16	-0622S	-190
FC650-10		-12	-3S	-5		-16	-16	-0622S	-205
FC650-12	-54S	-16	-5S	-6		-20	-20	-0630S	-254
FC659-06	-3S	-12	-3S	-5		-16	-16	-0630S	-205
FC659-08	-4S	-12	-4S	-6		-20	-18	-0630S	-239
FC659-10	-5S	-16	-5S	-8		-20	-20	-0630S	-280
FC659-12	-6S	-16	-6S	-24		-24	-26	-0630S	-300
FC659-16	-7S	-22	-7S	-11		-28	-28	-0630S	-381
FC659-20	-8S	-22	-8S	-28		-32			
FC693-04	-1S	-8	-13S	-2		-12	-12	0622S	
FC693-06	-1S	-10	-2S	-4		-16	-16	-0622S	
FC693-08	-3S	-12	-3S	-5		-18	-18	-0622S	
FC699-04	-12S	-6	-1S	-2		-12	-12	-0622S	
FC699-06	-14S	-10	-2S	-4		-16	-16	-0622S	-174
FC699-08	-3S	-12	-3S	-5		-16	-16	-0630S	-205
FC699-10	-4S	-12	-4S	-6		-20	-18	-0630S	-239
FC699-12	-5S	-16	-5S	-8		-20	-22	-0630S	-280
FC735-16	-7S	-22	-7S	-10	222005-15C	-24	-28	-0648S	-357
FC736-06	-3S	-12	-3S	-5		-16	-16	-0630S	-205
FC736-08	-4S	-12	-4S	-6		-20	-18	-0630S	-239
FC736-10	-5S	-16	-5S	-8		-20	-20	-0630S	-280
FC736-12	-6S	-16	-6S	-24		-24	-26	-0630S	-300
FC736-16	-7S	-22	-7S	-11		-28	-28	-0630S	-381
FC736-20	-8S	-22	-8S	-28		-32	-30	-0648S	
GH120-4	-1S	-8	-13S	-2		-12	-12	-0622S	-137
GH120-6	-2S	-10	-2S	-3		-16	-16	-0622S	-171
GH120-8	-14S	-12	-3S	-5		-16	-18	-0622S	-205
GH120-10	-54S	-16	-5S	-6		-20	-20	-0630S	-239
GH120-12	-5S	-16	-6S	-9		-22	-22	-0648S	-280
GH120-16	-7S	-22	-7S	-10		-24	-28	-0648S	-357
GH120-20	-9S	-30	-8S			-32	-30	-0648S	-422
GH120-24	-10S	-30	-15S	-29		-38	-38	-0648S	-508
GH120-32	-13S	-30	-12S	-30		-46	-46	-0664C	-635
GH194-4	-1S	-6	-1S	-1		-12	-11	-0622S	-137
GH194-6	-2S	-10	-2S	-3		-16	-14	-0622S	-174
GH194-8	-15S	-10	-3S	-5		-16	-16	-0622S	-205
GH194-12	-4S	-12	-4S	-6		-20	-18	-0633S	
GH194-10	-4S	-12	-4S	-6		-20	-18	-0630S	-239
GH194-12	-5S	-16	-5S	-8		-24	-22	-0648S	-280

*Sizes indicated are based on Hose O.D. only. If sleeve is to be placed over fittings, a larger sleeve size may be required, depending on type of fitting used.

Hose Accessories

AQ Selection Chart

PART #	STEEL COIL SPRING* 900564 (DASH SIZE)	PROT. COIL SLEEVE 900952 (DASH SIZE)	STEEL PROT. COIL SLEEVE* 900705 (DASH SIZE)	SUPPORT CLAMP 900729 (DASH SIZE)	INTERNAL SUPPORT COIL	NYLON SLEEVE* FC425 (DASH SIZE)	FIRESLEEVE* 624 (DASH SIZE)	FIRESLEEVE CLAMP FF9217 (DASH SIZE)	HEAVY DUTY SUPPORT CLAMP FF9031 (DASH SIZE)
GH194-16	-6S	-22	-6S	-25		-24	-26	-0648S	-357
GH194-20	-9S	-30	-8S	-1		-32	-30	-0648S	-445
GH195-4	-1S	-8	-13S	-2		-12	-12	-0622S	-150
GH195-6	-1S	-10	-2S	-4		-16	-16	-0622S	-190
GH195-8	-3S	-12	-3S	-5		-18	-18	-0622S	-222
GH195-10	-54S	-16	-5S	-6		-20	-20	-0630S	-266
GH195-12	-5S	-16	-6S	-9		-22	-22	-0648S	-300
GH195-16	-7S	-22	-9S	-10		-28	-28	-0648S	-381
GH195-20	-8S	-30	-10S	-12		-32	-32	-0664C	-483
GH195-24	-10S	-30	-11S	-13		-38	-38	-0648S	
GH195-32	-13S	-30	-12S	-30		-46	-46	-0664C	-635
GH466-20	-8S	-30	-8S	-13		-38	-38	-0648S	-508
GH493-6	-15S	-12	-3S	-5		-16	-16	-0622S	-205
GH493-8	-3S	-12	-4S	-6		-20	-20	-0648S	-239
GH493-10	-4S	-16	-5S	-8		-20	-22	-0648S	-280
GH493-12	-5S	-16	-6S	-27		-24	-24	-0648S	-300
GH493-16	-7S	-22	-7S	-10		-28	-28	-0648S	-381
GH493-20	-8S	-22	-10S	-28		-32	-38	-0648S	
GH493-24	-8S	-30	-10S	-29		-38	-38	-0648S	
GH493-32	-13S	-30	-11S	-31		-46	-46	-0664S	
GH506-12	-6S	-16	-6S	-24		-24	-26	-0648S	-320
GH506-16	-7S	-22	-7S	-10		-28	-30	-0648S	-381
GH506-20	-8S	-22	-9S	-28		-32	-32	-0648S	-445
GH663-4	-1S	-6	-1S	-1		-12	-11	-0622S	-137
GH663-6	-2S	-10	-2S	-3		-16	-14	-0622S	-174
GH663-8	-15S	-10	-3S	-5		-16	-16	-0622S	-205
GH663-12	-5S	-16	-5S	-8		-24	-22	-0648S	-280
GH663-16	-7S	-22	-6S	-25		-24	-26	-0648S	-357
GH663-20	-9S	-30	-8S	-12		-32	-30	-0648S	-422
GH663-24	-8S	-30	-8S	-13		-38	-38	-0648S	-483
GH663-32	-13S	-30	-12S	-30		-46	-46	-0664C	-635
GH681-4	-1S	-6	-1S	-1		-12	-11	-0622S	-127
GH681-6	-12S	-10	-2S	-21		-16	-14	-0622S	-160
GH681-8	-14S	-12	-3S	-4		-16	-16	-0622S	-205
GH781-4	-1S	-8	-13S	-2		-12	-12	-0622S	-137
GH781-6	-2S	-10	-2S	-3		-16	-16	-0622S	-174
GH781-8	-14S	-12	-3S	-5		-16	-18	-0622S	-205
GH781-10	-4S	-12	-5S	-6		-20	-18	-0630S	-239
GH781-12	-5S	-16	-14S	-9		-24	-22	-0648S	-280
GH781-16	-7S	-22	-7S	-10		-24	-28	-0648S	-357
GH781-20	-7S	-22	-9S	-12		-28	-28	-0648S	-422
GH781-24	-8S	-30	-8S	-13		-38	-38	-0648S	-508

*Sizes indicated are based on Hose O.D. only. If sleeve is to be placed over fittings, a larger sleeve size may be required, depending on type of fitting used.

Hose Accessories

AQ Selection Chart

PART #	STEEL PROT. COIL SPRING* 900564 (DASH SIZE)	PLASTIC COIL SLEEVE 900952 (DASH SIZE)	STEEL PROT. COIL SLEEVE* 900705 (DASH SIZE)	SUPPORT CLAMP 900729 (DASH SIZE)	INTERNAL SUPPORT COIL	NYLON SLEEVE* FC425 (DASH SIZE)	FIRE SLEEVE* 624 (DASH SIZE)	FIRE SLEEVE CLAMP FF9217 (DASH SIZE)	HEAVY DUTY SUPPORT CLAMP FF9031 (DASH SIZE)
GH781-32	-13S	-30	-12S	-30		-46	-46	-0664C	-635
GH793-4	-1S	-8	-13S	-2		-12	-12	-0622S	-150
GH793-6	-15S	-10	-2S	-4		-16	-16	-0622S	-190
GH793-8	-3S	-12	-3S	-5		-16	-18	-0622S	-222
GH793-10	-4S	-16	-5S	-6		-20	-20	-0630S	-266
GH793-12	-5S	-16	-6S	-9		-20	-22	-0648S	-300
GH793-16	-7S	-22	-9S	-10		-24	-28	-0648S	-381
GH793-20	-8S	-30	-10S	-12		-32	-32	-0664C	-483
GH793-24	-10S	-30	-10S	-13		-38	-38	-0648S	
GH793-32	-13S	-30	-12S	-30		-46	-46	-0664C	-635

*Sizes indicated are based on Hose O.D. only. If sleeve is to be placed over fittings, a larger sleeve size may be required, depending on type of fitting used.

Hose Sleeves and Guards

WH Selection Chart

HOSE TYPE	DASH SIZE	HOSE CLAMP	ROUND WIRE SPRING GUARD	FLAT WIRE SPRING GUARD	NYLON (.45) ABRASION SLEEVE	NYLON (.90) ABRASION SLEEVE	SILICONE FIBERGLASS FIRESLEEVE	POLY HOSE GUARD
H009	04	HK0913	A1901	A2901	A4900	A3900	A6910	A9901
	05	HK1013	A1902	A2902	A4900	A4900	A6914	A9901
	06	HK1113	A1903	A2903	A4901	A3901	A6916	A9901
	08	HK1313	A1905	A2905	A4901	A3901	A6916	A9902
	12	HK1813	A1909	A2909	A4902	A3902	A6920	A9903
H017	04	HK1013	A1902	A2902	A4900	A3900	A6912	A9901
	06	HK1313	A1905	A2905	A4900	A3900	A6914	A9902
	08	HK1613	A1907	A2907	A4901	A3901	A6920	A9902
	12	HK2117	A1911	A2911	A4903	A3903	A6924	A9903
	16	HK2517	A1913	A2913	A4904	A3904	A6928	A9903
	20	HK2917	A1915	A2915	A4906	A3906	A6932	A9904
H039	12	HK2117	A1913	A2913	A4904	A3904	A6928	A9903
	16	HK2517	A1915	A2915	A4905	A3605	A6932	A9904
	20	HK2917	A1915	A2915	A4906	A3906	A6932	A9904
	24	HK3317	A1917	A2917	A4907	A3907	A6936	A9904
	32	HK3817	-	-	A4908	A3908	A6948	A9905
H039H	12	HK2117	A1913	A2913	A4904	A3904	A6928	A9903
	16	HK2517	A1915	A2915	A4905	A3605	A6932	A9904
	20	HK2917	A1915	A2915	A4906	A3906	A6932	A9904
	24	HK3317	A1917	A2917	A4907	A3907	A6936	A9904
	32	HK3817	-	-	A4908	A3908	A6948	A9905
H057	03	HK0709	A1900	A2900	A4900	A3900	A6910	A9900
	04	HK1013	A1901	A2901	A4900	A3900	A6912	A9901
	05	HK1013	A1902	A2902	A4900	A3900	A6914	A9901
	06	HK1113	A1903	A2903	A4900	A3900	A6914	A9901
	07	HK1213	A1904	A2904	A4901	A3901	A6916	A9902
	08	HK1313	A1905	A2905	A4901	A3901	A6916	A9902
H059	04	HK0913	A1901	A2901	A4900	A3900	A6912	A9901
	05	HK1013	A1902	A2902	A4900	A3900	A6912	A9901
	06	HK1213	A1904	A2904	A4901	A3901	A6916	A9902
	08	HK1313	A1905	A2905	A4901	A3901	A6916	A9902
	10	HK1613	A1907	A2907	A4902	A3902	A6916	A9902
	12	HK1813	A1909	A2909	A4904	A3904	A6924	A9903
	16	HK2117	A1910	A2910	A4905	A3905	A6928	A9903
	20	HK2517	A1913	A2913	A4906	A3906	A6928	A9903
H069	04	HK0913	A1901	A2901	A4900	A3900	A6912	A9901
	05	HK1013	A1905	A2905	A4900	A3900	A6912	A9901
	06	HK1213	A1905	A2905	A4901	A3901	A6912	A9902
	08	HK1413	A1905	A2905	A4901	A3901	A6916	A9902
	10	HK1613	A1907	A2907	A4902	A3902	A6916	A9902
	12	HK1913	A1909	A2909	A4903	A3903	A6920	A9903
	16	HK2117	A1910	A2910	A4904	A3904	A6924	A9903
	20	HK2517	A1913	A2913	A4906	A3906	A6928	A9903
	24	HK2117	A1916	A2916	A4907	A3907	A6932	A9904
	32	-	A1919	A2919	-	-	A6940	A9904
	40	-	-	-	-	-	A6948	A9905
	48	-	-	-	-	-	-	-

Hose Sleeves and Guards

WH Selection Chart

HOSE TYPE	DASH SIZE	HOSE CLAMP	ROUND WIRE SPRING GUARD	FLAT WIRE SPRING GUARD	NYLON (.45) ABRASION SLEEVE	NYLON (.90) ABRASION SLEEVE	SILICONE FIBERGLASS FIRESLEEVE	POLY HOSE GUARD
H077	04	HK0913	A1902	A2902	A4900	A3900	A6912	A9901
	05	HK1013	A1902	A2903	A4900	A3900	A6914	A9901
	06	HK1113	A1903	A2903	A4901	A3901	A6914	A9901
H100	04	HK0913	A1900	A2900	A4900	A3900	A6912	A9901
	05	HK1013	A1903	A2903	A4900	A3900	A6912	A9901
	06	HK1113	A1903	A2903	A4900	A3900	A6912	A9902
	08	HK1313	A1905	A2905	A4901	A3901	A6916	A9902
	10	HK1613	A1907	A2907	A4902	A3902	A6920	A9902
	12	HK1813	A1908	A2908	A4903	A3903	A6924	A9903
H101	04	HK0913	A1902	A2902	A4900	A3900	A6910	A9901
	05	HK1013	A1903	A2903	A4900	A3900	A6912	A9901
	06	HK1113	A1903	A2903	A4900	A3900	A6912	A9901
	08	HK1413	A1905	A2905	A4902	A3902	A6916	A9902
	10	HK1613	A1907	A2907	A4903	A3903	A6920	A9902
	12	HK1813	A1908	A2908	A4903	A3903	A6924	A9903
H104	04	HK1903	A1902	A2902	A4900	A3900	A6912	A9901
	06	HK1213	A1904	A2904	A4900	A3900	A6914	A9902
	08	HK1413	A1907	A2907	A4902	A3902	A6920	A9902
	10	HK1613	A1907	A2907	A4903	A3903	A6924	A9902
	12	HK1913	A1910	A2910	A4903	A3903	A6924	A9903
	16	HK2317	A1913	A2913	A4904	A3904	A6928	A9903
	20	HK2117	A1916	A2916	A4906	A3906	A6936	A9904
H105	04	HK1113	A1903	A2903	A4900	A3900	A6914	A9901
	06	HK1313	A1905	A2905	A4903	A3903	A6914	A9902
	08	HK1513	A1907	A2907	A4904	A3904	A6924	A9902
	12	HK2017	A1910	A2910	A4904	A3904	A6924	A9903
	16	HK2517	A1913	A2913	A4906	A3906	A6932	A9903
H114	04	HK0913	A1902	A2902	A4900	A3900	A6912	A9901
	06	HK1113	A1904	A2904	A4900	A3900	A6914	A9901
	08	HK1413	A1906	A2906	A4902	A3902	A6920	A9902
H115	04	HK1113	A1902	A2902	A4900	A3900	A6912	A9901
	05	HK1113	A1904	A2904	A4900	A3900	A6912	A9901
	06	HK1213	A1904	A2904	A4900	A3900	A6914	A9902
	08	HK1513	A1907	A2907	A4901	A3901	A6920	A9902
	12	HK2017	A1910	A2910	A4903	A3903	A6924	A9903
	16	HK2317	A1913	A2913	A4904	A3904	A6928	A9903
	20	HK2117	A1916	A2916	A4906	A3906	A6936	A9904
	24	HK3317	A1917	A2917	A4907	A3907	A6940	A9904
H145	04	HK0913	A1900	A2900	A4900	A3900	A6912	A9900
	06	HK1113	A1904	A2904	A4901	A3901	A6916	A9901
	08	HK1413	A1906	A2906	A4901	A3901	A6916	A9902
	10	HK1613	A1908	A2908	A4903	A4903	A6924	A9902
	12	HK1813	A1910	A2910	A4903	A3903	A6924	A9902
	16	HK2317	A1913	A2913	A4904	A3904	A6928	A9903

Hose Sleeves and Guards

WH Selection Chart

HOSE TYPE	DASH SIZE	HOSE CLAMP	ROUND WIRE SPRING GUARD	FLAT WIRE SPRING GUARD	NYLON (.45) ABRASION SLEEVE	NYLON (.90) ABRASION SLEEVE	SILICONE FIBERGLASS FIRESLEEVE	POLY HOSE GUARD
H145R	04	HK0913	A1900	A2900	A4900	A3900	A6912	A9900
	06	HK1113	A1904	A2904	A4901	A3901	A6916	A9901
	08	HK1413	A1906	A2906	A4901	A3901	A6916	A9902
	10	HK1613	A1908	A2908	A4903	A4903	A6924	A9902
	12	HK1813	A1910	A2910	A4903	A3903	A6924	A9902
	16	HK2317	A1913	A2913	A4904	A3904	A6928	A9903
H146	04	HK0913	A1902	A2902	A4900	A3900	A6912	A9901
	06	HK1213	A1905	A2905	A4901	A3901	A6914	A9902
	08	HK1413	A1906	A2906	A4901	A3901	A6920	A9903
H166	04	HK0913	A1900	A2900	A4900	A3900	A6912	A9901
	05	HK1013	A1902	A2902	A4900	A3900	A6912	A9901
	06	HK1013	A1904	A2904	A4901	A3901	A6916	A9902
	08	HK1413	A1905	A2905	A4901	A3901	A6916	A9902
	10	HK1613	A1907	A2907	A4901	A3901	A6920	A9902
	12	HK1913	A1910	A2910	A4903	A3903	A6924	A9903
	16	HK2117	A1911	A2911	A4905	A3905	A6932	A9903
	20	HK2517	A1913	A2913	A4905	A3905	A6940	A9903
H169	04	HK1013	A1901	A2901	A4900	A3900	A6914	A9901
	05	HK1113	A1902	A2902	A4900	A3900	A6914	A9901
	06	HK1213	A1904	A2904	A4901	A3901	A6916	A9902
	08	HK1413	A1905	A2905	A4901	A3901	A6916	A9902
	10	HK1613	A1907	A2907	A4901	A3901	A6920	A9902
	12	HK1913	A1910	A2910	A4903	A3903	A6924	A9903
	16	HK2117	A1912	A2912	A4905	A3905	A6932	A9903
	20	HK2517	A1913	A2913	A4904	A3904	A6940	A9903
	24	HK2917	A1916	A2916	A4907	A3907	A6948	A9904
	32	HK3417	A1919	A2919	-	-	-	A9904
H190	04	HK1013	A1902	A2902	A4900	A3900	A6914	A9901
	06	HK1213	A1904	A2904	A4901	A3901	A6916	A9902
	08	HK1413	A1906	A2906	A4901	A3901	A6916	A9902
	10	HK1613	A1908	A2908	A4901	A3901	A6920	A9902
	12	HK1913	A1910	A2910	A4903	A3903	A6924	A9903
	16	HK2517	A1913	A2913	A4905	A3905	A6932	A9903
H190H	04	HK1013	A1902	A2902	A4900	A3900	A6914	A9901
	06	HK1213	A1904	A2904	A4901	A3901	A6916	A9902
	08	HK1413	A1906	A2906	A4901	A3901	A6916	A9902
	10	HK1613	A1908	A2908	A4901	A3901	A6920	A9902
	12	HK1913	A1910	A2910	A4903	A3903	A6924	A9903
	16	HK2517	A1913	A2913	A4905	A3905	A6932	A9903
H201	04	HK0913	A1901	A2901	A4900	A3900	A3612	A9901
	06	HK1113	A1903	A2903	A4901	A3901	A6914	A9901
	08	HK1313	A1905	A2905	A4901	A3901	A6916	A9902
	10	HK1613	A1907	A2907	A4902	A3902	A6920	A9902
	12	HK1813	A1908	A2908	A4903	A3903	A6924	A9903

Hose Sleeves and Guards

WH Selection Chart

HOSE TYPE	DASH SIZE	HOSE CLAMP	ROUND WIRE SPRING GUARD	FLAT WIRE SPRING GUARD	NYLON (.45) ABRASION SLEEVE	NYLON (.90) ABRASION SLEEVE	SILICONE FIBERGLASS FIRESLEEVE	POLY HOSE GUARD
H209	04	HK0809	A1900	A2900	A4900	A3900	A6910	A9900
	05	HK0913	A1902	A2902	A4900	A3900	A6914	A9900
	06	HK1013	A1903	A2903	A4901	A3901	A6914	A9900
	08	HK1213	A1905	A2905	A4901	A3901	A6920	A9902
H213	04	HK0913	A1901	A2901	A4900	A3900	A6910	A9900
	05	HK1013	A1902	A2902	A4900	A3900	A6914	A9900
	06	HK1113	A1903	A2903	A4900	A3900	A6914	A9901
	08	HK1313	A1905	A2905	A4901	A3901	A6920	A9902
	10	HK1413	A1907	A2907	A4902	A3902	A6920	A9902
	12	HK1713	A1908	A2908	A4903	A3903	A6924	A9902
	16	HK2017	A1911	A2911	A4904	A3904	A6928	A9903
H229	04	HK0913	A1901	A2901	A4900	A3900	A6910	A9901
	06	HK1213	A1904	A2904	A4901	A3901	A6914	A9902
	08	HK1413	A1905	A2905	A4902	A3902	A6924	A9902
	10	HK1613	A1907	A2907	A4902	A3902	A6924	A9902
H229	12	HK2617	A1912	A2912	A4905	A3905	A6928	A9903
	16	HK2117	A1912	A2912	A4906	A3906	A6932	A9906
H239	04	HK0913	A1901	A2901	A4900	A3900	A6912	A9901
	08	HK1313	A1905	A2905	A4901	A3901	A6920	A9902
	10	HK1613	A1907	A2907	A4902	A3902	A6920	A9902
	12	HK1813	A1910	A2910	A4905	A3905	A6928	A9903
	16	HK2117	A1912	A2912	A4906	A3906	A6932	A9903
	20	HK2517	A1913	A2913	A4904	A3904	A6940	A9903
H243	03	HK0709	A1900	A2900	A4900	A3900	A6910	A9900
	04	HK0709	A1900	A2900	A4900	A3900	A6914	A9900
	05	HK0809	A1902	A2902	A4900	A3900	A6914	A9901
	06	HK0913	A1903	A2903	A4901	A3901	A6920	A9901
	08	HK1113	A1905	A2905	A4902	A3902	A6920	A9902
	12	HK1513	A1909	A2909	A4904	A3904	A6924	A9903
	16	HK1913	A1911	A2911	A4905	A3905	A6928	A9904
H245	04	HK1013	A1902	A2902	A4900	A3900	A6914	A9901
	06	HK1013	A1904	A2904	A4903	A3903	A6920	A9902
	08	HK1213	A1906	A2906	A4904	A3904	A6924	A9902
	10	HK1413	A1907	A2907	A4904	A3904	A6924	A9902
	12	HK1613	A1910	A2910	A4905	A3905	A6928	A9903
	16	HK2317	A1913	A2913	A4906	A3906	A6932	A9903
	20	HK2917	A1916	A2916	A4907	A3907	A6940	A9904
H265	04	HK0913	A1902	A2902	A4900	A3900	A6914	A9901
	06	HK1213	A1904	A2904	A4901	A3901	A6916	A9901
	08	HK1413	A1905	A2905	A4902	A3902	A6920	A9902
	12	HK1813	A1910	A2910	A4904	A3904	A6928	A9903
	16	HK2217	A1913	A2913	A4905	A3905	A6932	A9903

Hose Sleeves and Guards

WH Selection Chart

HOSE TYPE	DASH SIZE	HOSE CLAMP	ROUND WIRE SPRING GUARD	FLAT WIRE SPRING GUARD	NYLON (.45) ABRASION SLEEVE	NYLON (.90) ABRASION SLEEVE	SILICONE FIBERGLASS FIRESLEEVE	POLY HOSE GUARD
H275	03	HK0809	A1900	A2900	A4900	A3900	A6912	A9900
	04	HK0913	A1902	A2902	A4900	A3900	A6914	A9901
	06	HK1113	A1903	A2903	A4901	A3901	A6916	A9901
	08	HK1413	A1905	A2905	A4902	A3902	A6920	A9902
	12	HK1813	A1907	A2907	A4904	A3904	A6924	A9902
	16	HK2217	A1913	A2913	A4905	A3905	A6928	A9903
	20	HK2917	A1916	A2916	A4907	A3907	A6936	A9904
	24	HK3217	A1917	A2917	A4908	A3908	A6940	A9904
	32	HK3817	-	-	-	-	A6948	A9904
H277	03	HK0709	A1900	A2900	A4900	A3900	A6910	A9900
	04	HK0709	A1900	A2900	A4900	A3900	A6914	A9900
	05	HK0809	A1900	A2900	A4901	A3901	A6920	A9902
	06	HK0913	A1903	A2903	A4902	A3902	A6920	A9902
	08	HK1113	A1903	A2903	A4901	A3901	A6920	A9902
	12	HK1513	A1907	A2907	A4904	A3904	A6928	A9903
	16	HK1913	A1910	A2910	A4905	A3905	A6932	A9903
	H280	04	HK1013	A1901	A2901	A4900	A3900	A6914
	06	HK1213	A1904	A2904	A4901	A3901	A6920	A9902
	08	HK1413	A1906	A2906	A4901	A3901	A6920	A9902
	10	HK1613	A1907	A2907	A4904	A3904	A6928	A9903
	12	HK1913	A1910	A2910	A4904	A3904	A6928	A9903
	16	HK2517	A1913	A2913	A4905	A3905	A6932	A9903
H285	04	HK0913	A1900	A2900	A4900	A3900	A6914	A9900
	06	HK1213	A1903	A2903	A4901	A3901	A6916	A9901
	08	HK1413	A1905	A2905	A4901	A3901	A6920	A9902
	12	HK1813	A1910	A2910	A4904	A3904	A6924	A9903
	16	HK2217	A1912	A2912	A4905	A3905	A6928	A9903
H290	04	HK1113	A1903	A2903	A4900	A3900	A6914	A9901
	06	HK1313	A1905	A2905	A4901	A3901	A6916	A9902
	08	HK1513	A1907	A2907	A4902	A3902	A6920	A9902
	10	HK1713	A1909	A2909	A4904	A3904	A6924	A9903
	12	HK2017	A1910	A2910	A4904	A3904	A6928	A9903
	16	HK2517	A1913	A2913	A4904	A3904	A6932	A9903
H290H	04	HK1113	A1903	A2903	A4900	A3900	A6914	A9901
	06	HK1313	A1905	A2905	A4901	A3901	A6916	A9902
	08	HK1513	A1907	A2907	A4902	A3902	A6920	A9902
	10	HK1713	A1909	A2909	A4904	A3904	A6924	A9903
	12	HK2017	A1910	A2910	A4904	A3904	A6928	A9903
	16	HK2517	A1913	A2913	A4904	A3904	A6932	A9903
H324	06	HK1313	A1905	A2905	A4900	A3900	A6924	A9902
H325	04	HK1013	A1903	A2903	A4900	A3900	A6914	A9901
	06	HK1313	A1905	A2905	A4900	A3900	A3616	A9902
	08	HK1513	A1907	A2907	A4901	A3901	A6920	A9902
	12	HK2017	A1910	A2910	A4904	A3904	A6928	A9903
	16	HK2517	A1913	A4913	A4904	A3904	A3932	A9903

Hose Sleeves and Guards

WH Selection Chart

HOSE TYPE	DASH SIZE	HOSE CLAMP	ROUND WIRE SPRING GUARD	FLAT WIRE SPRING GUARD	NYLON (.45) ABRASION SLEEVE	NYLON (.90) ABRASION SLEEVE	SILICONE FIBERGLASS FIRESLEEVE	POLY HOSE GUARD
H332	04	HK1013	A1903	A2903	A4900	A3900	A6914	A9901
	06	HK1313	A1905	A2905	A4900	A3900	A3616	A9902
	08	HK1513	A1907	A2907	A4901	A3901	A6920	A9902
	12	HK2017	A1910	A2910	A4904	A3904	A6928	A9903
	16	HK2517	A1913	A4913	A4904	A3904	A3932	A9903
H335	03	HK0913	A1901	A2901	A4900	A3900	A6916	A9901
	04	HK1113	A1903	A2903	A4901	A3901	A6916	A9902
	06	HK1313	A1904	A2904	A4902	A3902	A6920	A9902
	08	HK1513	A1907	A2907	A4902	A3902	A6924	A9902
	12	HK1913	A1910	A2910	A4903	A3903	A6924	A9903
	16	HK2517	A1913	A2913	A4905	A3905	A6928	A6603
H336	03	HK0913	A1901	A2901	A4900	A3900	A6916	A9901
	04	HK1113	A1903	A2903	A4901	A3901	A6916	A9902
	06	HK1313	A1904	A2904	A4902	A3902	A6920	A9902
	08	HK1513	A1907	A2907	A4902	A3902	A6924	A9903
	12	HK1913	A1910	A2910	A4903	A3903	A6924	A9903
	16	HK2517	A1913	A2913	A4905	A3905	A6928	A9902
H338	06	HK1313	A1905	A2905	A4900	A3900	A6920	A9902
	08	HK1513	A1907	A2907	A4901	A3901	A6920	A9902
H342	04	HK1013	A1900	A2900	A4900	A3900	A6910	A9901
	06	HK1213	A1904	A2904	A4900	A3900	A6912	A9901
	08	HK1513	A1905	A2905	A4900	A3900	A6914	A9902
	10	HK1813	A1908	A2908	A4901	A3901	A6920	A9902
	12	HK2017	A1910	A2910	A4902	A3902	A6920	A9903
	16	HK2617	A1913	A2913	A4904	A3904	A6928	A9903
H345	04	HK0913	A1900	A2900	A4900	A3900	A6916	A9901
	06	HK1113	A1904	A2904	A4900	A3900	A6920	A9902
	08	HK1313	A1905	A2905	A4901	A3901	A6924	A9902
H350	06	HK1313	A1904	A2904	A4901	A3901	A6916	A9902
	08	HK1513	A1906	A2906	A4901	A3901	A6916	A9902
	10	HK1813	A1908	A2908	A4904	A3904	A6924	A9903
	12	HK2017	A1910	A2910	A4905	A3905	A6928	A9903
	16	HK2517	A1913	A4913	A4906	A3906	A6936	A9903
H366	06	HK1213	A1904	A2904	A4901	A3901	A6916	A9902
	08	HK1413	A1905	A2905	A4901	A3901	A6916	A9902
H400	10	HK1713	A1909	A2909	A4903	A3903	A6920	A9903
H425	04	HK1113	A1903	A2903	A4900	A3900	A6916	A9902
	06	HK1313	A1905	A2905	A4900	A3900	A6916	A9902
	08	HK1513	A1907	A2907	A4902	A3902	A6920	A9902
	10	HK1713	A1909	A2909	A4903	A3903	A6920	A9903
	12	HK2017	A1911	A2911	A4903	A3903	A6924	A9903
	16	HK2517	A1913	A2913	A4905	A3905	A6928	A9903
	20	HK3117	A1916	A2916	A4906	A3906	A6936	A9904
	24	HK3417	A1919	A2919	A4907	A3907	A6940	A9904
	32	HK3817	-	-	-	-	-	A9905

Hose Sleeves and Guards

WH Selection Chart

HOSE TYPE	DASH SIZE	HOSE CLAMP	ROUND WIRE SPRING GUARD	FLAT WIRE SPRING GUARD	NYLON (.45) ABRASION SLEEVE	NYLON (.90) ABRASION SLEEVE	SILICONE FIBERGLASS FIRESLEEVE	POLY HOSE GUARD
H430	08	HK1613	A1908	A2908	A4904	A3904	A6924	A9903
	12	HK2117	A1912	A2912	A4905	A3905	A6928	A9903
	16	HK2517	A1913	A2913	A4906	A3906	A6936	A9903
	20	HK3117	A1916	A2916	A4907	A3907	A6940	A9904
	24	-	A1919	A2919	A4907	A3907	A6940	A9904
	32	HK3817	-	-	-	-	-	A9905
H430R	08	HK1613	A1908	A2908	A4904	A3904	A6924	A9903
	12	HK2117	A1912	A2912	A4905	A3905	A6928	A9903
	16	HK2517	A1913	A2913	A4906	A3906	A6936	A9903
	20	HK3117	A1916	A2916	A4907	A3907	A6940	A9904
	24	-	A1919	A2919	A4907	A3907	A6940	A9904
	32	HK3817	-	-	-	-	-	A9905
H435	04	HK0809	A1900	A2900	A4900	A3900	A6912	A9901
	05	HK1013	A1903	A2903	A4900	A3900	A6912	A9901
	06	HK1113	A1904	A2904	A4900	A3900	A6916	A9901
	08	HK1413	A1906	A2906	A4902	A3902	A6920	A9902
	12	HK1813	A1910	A2910	A4903	A3903	A6924	A9903
	16	HK2317	A1913	A2913	A4904	A3904	A6928	A9903
	20	HK2817	A1916	A2916	A4905	A3905	A6932	A9904
H436	04	HK0809	A1900	A2900	A4900	A3900	A6912	A9901
	05	HK1013	A1903	A2903	A4900	A3900	A6912	A9901
	06	HK1113	A1904	A2904	A4901	A3901	A6916	A9901
	08	HK1413	A1906	A2906	A4902	A3902	A6920	A9902
	12	HK1813	A1910	A2910	A4903	A3903	A6924	A9903
	16	HK2317	A1913	A2913	A4904	A3904	A6928	A9903
	20	HK2817	A1916	A2916	A4905	A3905	A6932	A9904
H461	08	HK1713	A1907	A2907	A4901	A3901	A6916	A9902
	12	HK2117	A1910	A2910	A4903	A3903	A6920	A9903
	16	HK2617	A1913	A2913	A4904	A3904	A6928	A9903
	20	HK3217	A1916	A2917	A4906	A3906	A6932	A9904
	24	HK3417	A1919	A1919	A4906	A3906	A6936	A9904
	32	HK3817	-	-	A4908	A3908	A6948	A9905
	36	HK4317	-	-	A4910	A3910	A6952	A9905
H464	12	HK2217	-	-	A4903	A3903	A6920	A9902
	16	HK2517	-	-	A4904	A3904	A6924	A9902
	20	HK3117	-	-	A4905	A3905	A6928	A9903
	24	HK3417	-	-	A4906	A3906	A6936	A9903
	32	HK3817	-	-	A4908	A3908	A6948	A9904
H470	08	HK1713	A1908	A2908	A4901	A3901	A6916	A9902
	12	HK2117	A1911	A2911	A4904	A3904	A6928	A9903
	16	HK2517	A1913	A2913	A4904	A3904	A6928	A9903
	20	HK3217	A1917	A2917	A4906	A3906	A6936	A9904
	24	HK3417	A1919	A2919	A4907	A3907	A6940	A9904
	32	HK3817	-	-	-	-	-	A9905

Hose Sleeves and Guards

WH Selection Chart

HOSE TYPE	DASH SIZE	HOSE CLAMP	ROUND WIRE SPRING GUARD	FLAT WIRE SPRING GUARD	NYLON (.45) ABRASION SLEEVE	NYLON (.90) ABRASION SLEEVE	SILICONE FIBERGLASS FIRESLEEVE	POLY HOSE GUARD
H545	04	HK1013	A1902	A2902	A4900	A3900	A6912	A9901
	06	HK1213	A1904	A2904	A4901	A3901	A6916	A9901
	08	HK1513	A1906	A2906	A4901	A3901	A6916	A9902
	10	HK1713	A1907	A2907	A4903	A3903	A6924	A9902
	12	HK2017	A1910	A2910	A4904	A3904	A6928	A9903
	16	HK2517	A1913	A2913	A4906	A3906	A6936	A9903
	H569	04	HK0913	A1901	A2901	A4900	A3900	A6912
05		HK1113	A1902	A2902	A4900	A3900	A6912	A9901
06		HK1213	A1904	A2904	A4901	A3901	A6916	A9902
08		HK1413	A1905	A2905	A4901	A3901	A6916	A9902
10		HK1613	A1907	A2907	A4901	A3901	A6916	A9902
12		HK1913	A1910	A2910	A4903	A3903	A6924	A9903
16		HK2117	A1911	A2911	A4904	A3904	A6928	A9903
20		HK2517	A1913	A2913	A4906	A3906	A6936	A9903
H757	06	HK1013	A1902	A2902	A4900	A3900	A6916	A9901
	08	HK1213	A1904	A2904	A4900	A3900	A6920	A9902
	10	HK1313	A1905	A2905	A4901	A3901	A6920	A9902
	12	HK1613	A1907	A2907	A4902	A3902	A6924	A9902
	14	HK1913	A1910	A2910	A4903	A3903	A6924	A9903



MURDOCK
industrial

Sales@MurdockIndustrial.com
www.HoseWarehouse.com

Phone: 330-535-7105
Fax: 330-535-1125

Skype:
MurdockIndustrial

Eaton
Hydraulics Operations USA
14615 Lone Oak Road
Eden Prairie, MN 55344
USA
Tel: 952-937-9800
Fax: 952-294-7722
www.hydraulics.eaton.com

Eaton
Hydraulics Operations Europe
Route de la Longeraie 7
1110 Morges
Switzerland
Tel: +41 (0) 21 811 4600
Fax: +41 (0) 21 811 4601

Eaton
Hydraulics Operations Asia Pacific
11th Floor Hong Kong New World Tower
300 Huaihai Zhong Road
Shanghai 200021
China
Tel: 86-21-6387-9988
Fax: 86-21-6335-3912

© 2007 Eaton Corporation
All Rights Reserved
Printed in USA
Document No. E-HOAS-MC001-E
Supersedes A-HOAS-MR001-E
December 2007



 **MURDOCK** | Sales@MurdockIndustrial.com | **Phone: 330-535-7105** | **Skype:**
industrial | www.HoseWarehouse.com | **Fax: 330-535-1125** | **MurdockIndustrial**